

5 55 566 0

eibe Matterhorn

made in germany









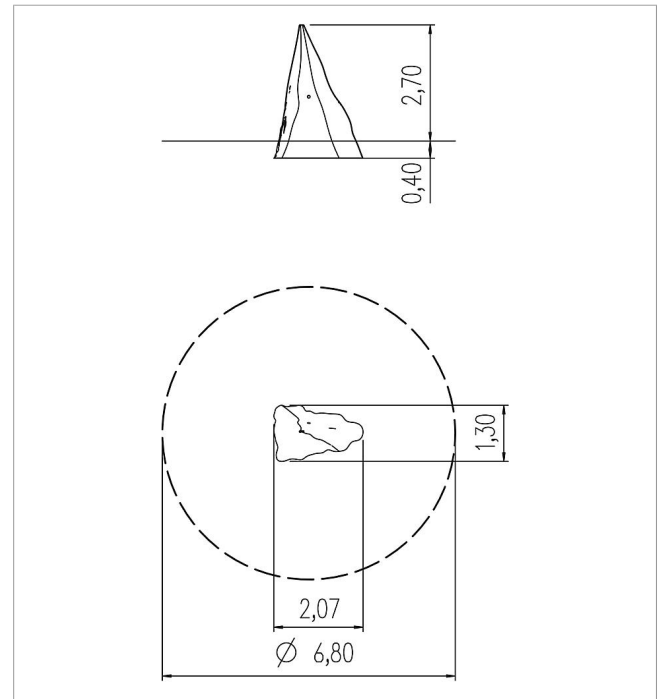

3+

Scope of delivery

1 Matterhorn 300 cm: GFRP



| | | |
|---|-----------------------|---------------------|
|  | Material | GFRP |
|  | Foundation level | FL 1 |
|  | Minimum space | Ø 680x450 cm |
|  | Free falling height | 270 cm |
|  | Impact protection net | 36,5 m ² |
|  | Foundations | 4x CF or 4x PFs |
|  | Assembly | 3 people/3 h |
|  | Largest section | 310x210x130 cm |
|  | Heaviest section | 150 kg |