



**Fitzpatrick  
Woolmer**

## Fusilier™ Notice Board

Our **Fusilier™** notice boards are built for demanding public environments. Robust and weather-resistant, they offer long-lasting durability with a sleek, professional finish. Available in single or double door options, they feature lockable doors for secure, tamper-resistant display.

Designed for practicality, they're low-maintenance and easy to update. Their clean lines and modern aesthetic make them ideal for civic and commercial settings, while their resilient construction ensures reliable performance in all conditions, year after year.

### Product features

- \* Stainless steel construction
- \* Can be supplied with or without a header board
- \* Robust stainless steel locks
- \* Gas struts to support doors when open
- \* Tough 4mm clear polycarbonate window
- \* Magnetic back board – magnets included
- \* Vent holes to minimise condensation
- \* Powdercoat finish to standard colour
- \* Standard sizes A2, A1 and A0
- \* 1 year manufacturer's warranty

**Fitzpatrick Woolmer Design & Publishing Limited**

Unit 7 Lakeside Park, Neptune Close, Rochester, Kent, ME2 4LT  
t: 01634 711 771 e: info@fwdp.co.uk w: fwdp.co.uk



By Appointment to His Majesty The King  
Manufacturer of Signs and Wayfinding  
Fitzpatrick Woolmer Design & Publishing Ltd, Kent

Specification applies to the standard product. Our range of options usually allow us to accommodate any differences you may require. Please contact us and we will be happy to support you in developing this specification to meet your requirements.

*Option delete/ update as appropriate*

**Manufacturer:** Fitzpatrick Woolmer,  
Unit 7 Lakeside Park, Neptune Close,  
Rochester, Kent, ME2 4LT.

**Tel:** 01634 711 771

**Email:** info@fwdp.co.uk

**Metal:** Stainless steel

**Grade:** 304

**Metal:** Aluminium

**Grade:** 1050

**Finish:** Powdercoat to BS EN 12206:2021 Part 1

**Colour:** RAL 9005 Black

**Fixings:** Stainless steel

**Type:** Security

**Weight:** 73kg

**Installation:** Posts extend 600mm below ground level

**Guarantee:** One year manufacturer's warranty

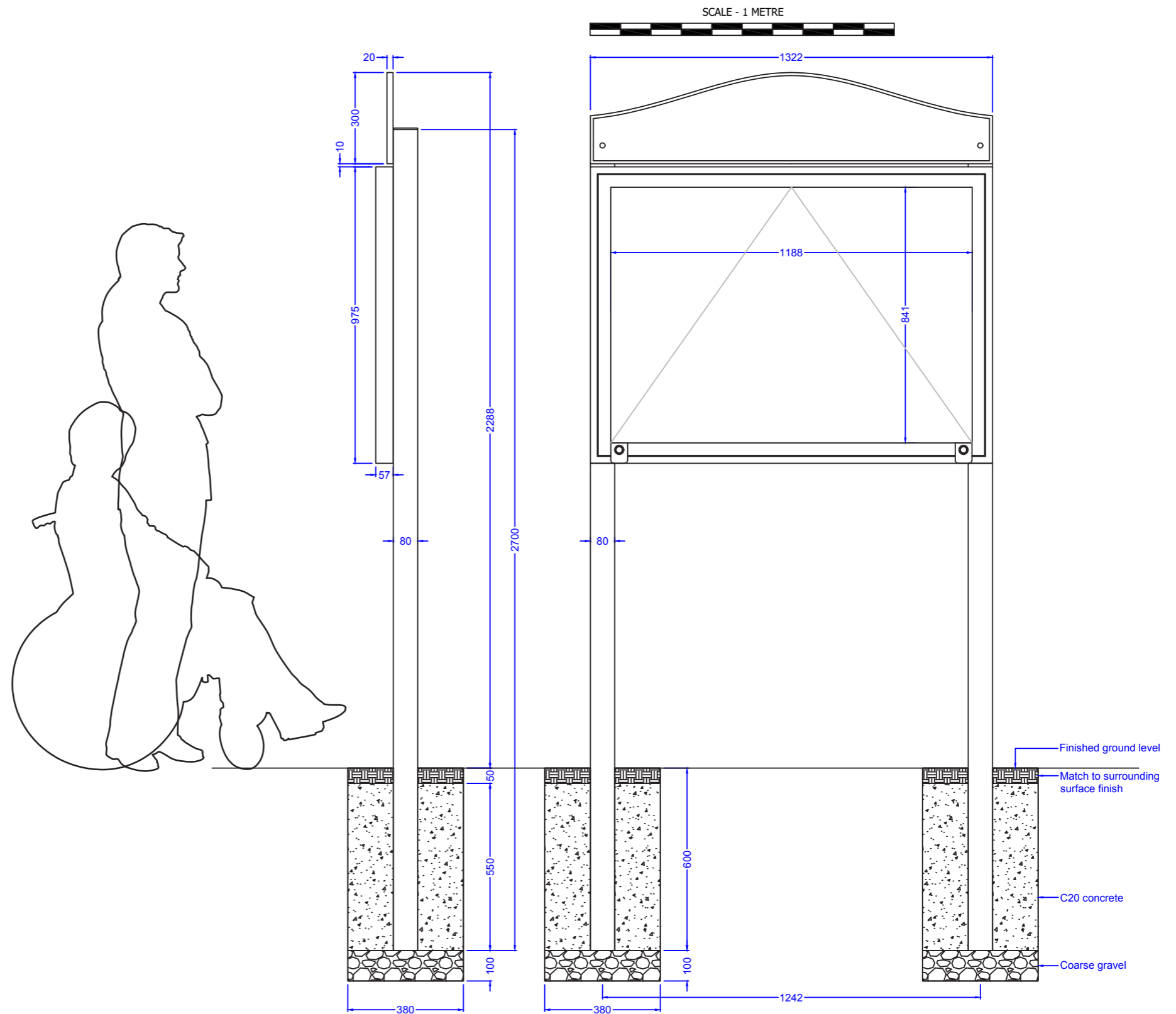

Note: All dimensions are indicative only. Footing details are subject to soil conditions and structural engineers recommendations.



Specification applies to the standard product. Our range of options usually allow us to accommodate any differences you may require. Please contact us and we will be happy to support you in developing this specification to meet your requirements.

Option delete/ update as appropriate

**Manufacturer:** Fitzpatrick Woolmer,  
Unit 7 Lakeside Park, Neptune Close,  
Rochester, Kent, ME2 4LT.

**Tel:** 01634 711 771

**Email:** info@fwdp.co.uk

**Metal:** Stainless steel

**Grade:** 304

**Metal:** Aluminium

**Grade:** 1050

**Finish:** Powdercoat to BS EN 12206:2021 Part 1

**Colour:** RAL 9005 Black

**Fixings:** Stainless steel

**Type:** Security

**Weight:** 80kg

**Installation:** Posts extend 600mm below ground level

**Guarantee:** One year manufacturer's warranty

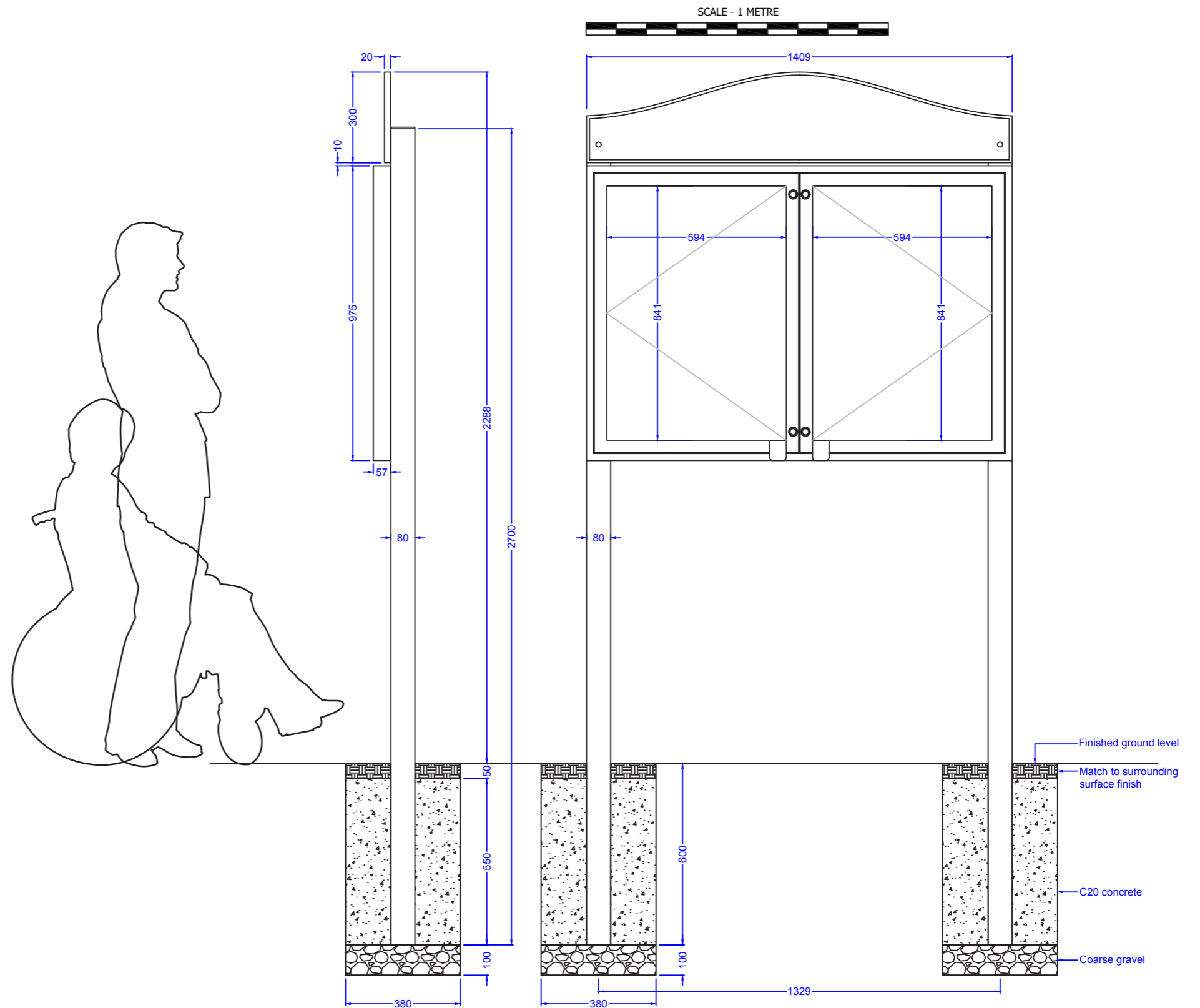

Note: All dimensions are indicative only. Footing details are subject to soil conditions and structural engineers recommendations.

Specification applies to the standard product. Our range of options usually allow us to accommodate any differences you may require. Please contact us and we will be happy to support you in developing this specification to meet your requirements.

Option delete/ update as appropriate

**Manufacturer:** Fitzpatrick Woolmer,  
Unit 7 Lakeside Park, Neptune Close,  
Rochester, Kent, ME2 4LT.

**Tel:** 01634 711 771

**Email:** info@fwdp.co.uk

**Metal:** Stainless steel

**Grade:** 304

**Finish:** Powdercoat to BS EN 12206:2021 Part 1

**Colour:** RAL 9005 Black

**Fixings:** Stainless steel

**Type:** Security

**Weight:** 67kg

**Installation:** Posts extend 600mm below ground level

**Guarantee:** One year manufacturer's warranty

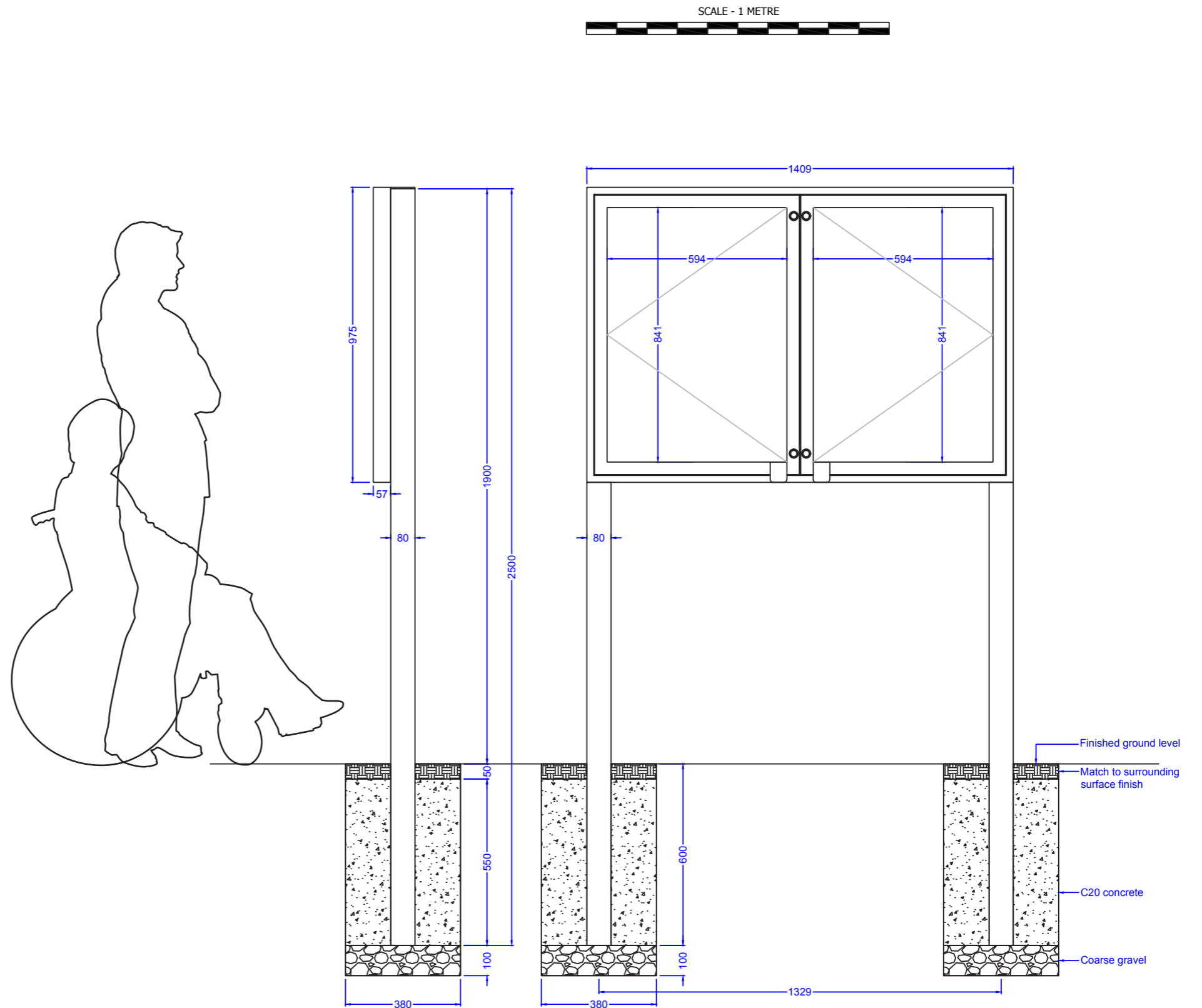

Note: All dimensions are indicative only. Footing details are subject to soil conditions and structural engineers recommendations.

Specification applies to the standard product. Our range of options usually allow us to accommodate any differences you may require. Please contact us and we will be happy to support you in developing this specification to meet your requirements.

Option delete/ update as appropriate

**Manufacturer:** Fitzpatrick Woolmer,  
Unit 7 Lakeside Park, Neptune Close,  
Rochester, Kent, ME2 4LT.

**Tel:** 01634 711 771

**Email:** info@fwdp.co.uk

**Metal:** Stainless steel

**Grade:** 304

**Metal:** Aluminium

**Grade:** 1050

**Finish:** Powdercoat to BS EN 12206:2021 Part 1

**Colour:** RAL 9005 Black

**Fixings:** Stainless steel

**Type:** Security

**Weight:** 53kg

**Installation:** Posts extend 600mm below ground level

**Guarantee:** One year manufacturer's warranty

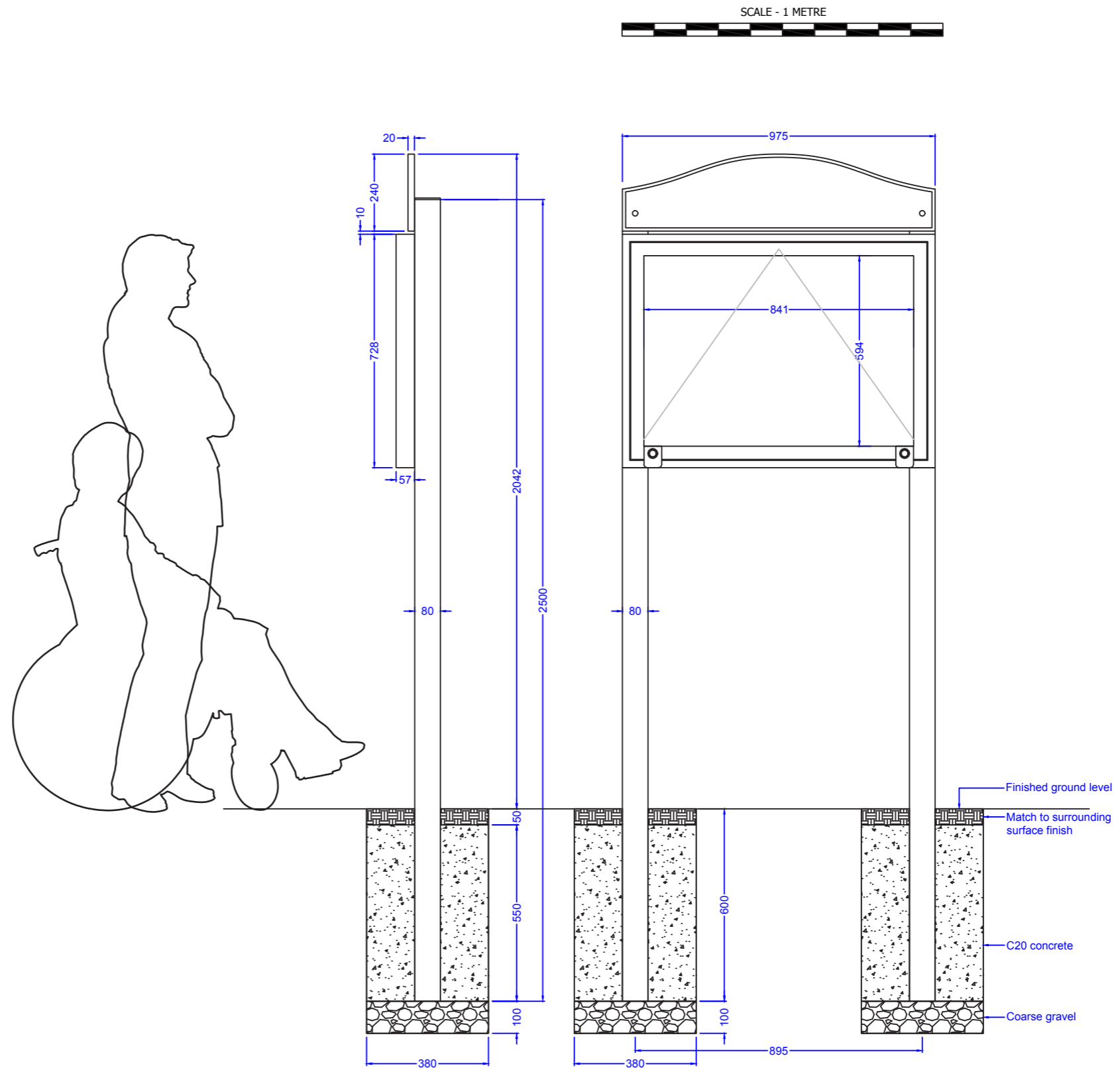

Note: All dimensions are indicative only. Footing details are subject to soil conditions and structural engineers recommendations.

Specification applies to the standard product. Our range of options usually allow us to accommodate any differences you may require. Please contact us and we will be happy to support you in developing this specification to meet your requirements.

Option delete/ update as appropriate

**Manufacturer:** Fitzpatrick Woolmer,  
Unit 7 Lakeside Park, Neptune Close,  
Rochester, Kent, ME2 4LT.

**Tel:** 01634 711 771

**Email:** info@fwdp.co.uk

**Metal:** Stainless steel

**Grade:** 304

**Finish:** Powdercoat to BS EN 12206:2021 Part 1

**Colour:** RAL 9005 Black

**Fixings:** Stainless steel

**Type:** Security

**Weight:** 46kg

**Installation:** Posts extend 600mm below ground level

**Guarantee:** One year manufacturer's warranty

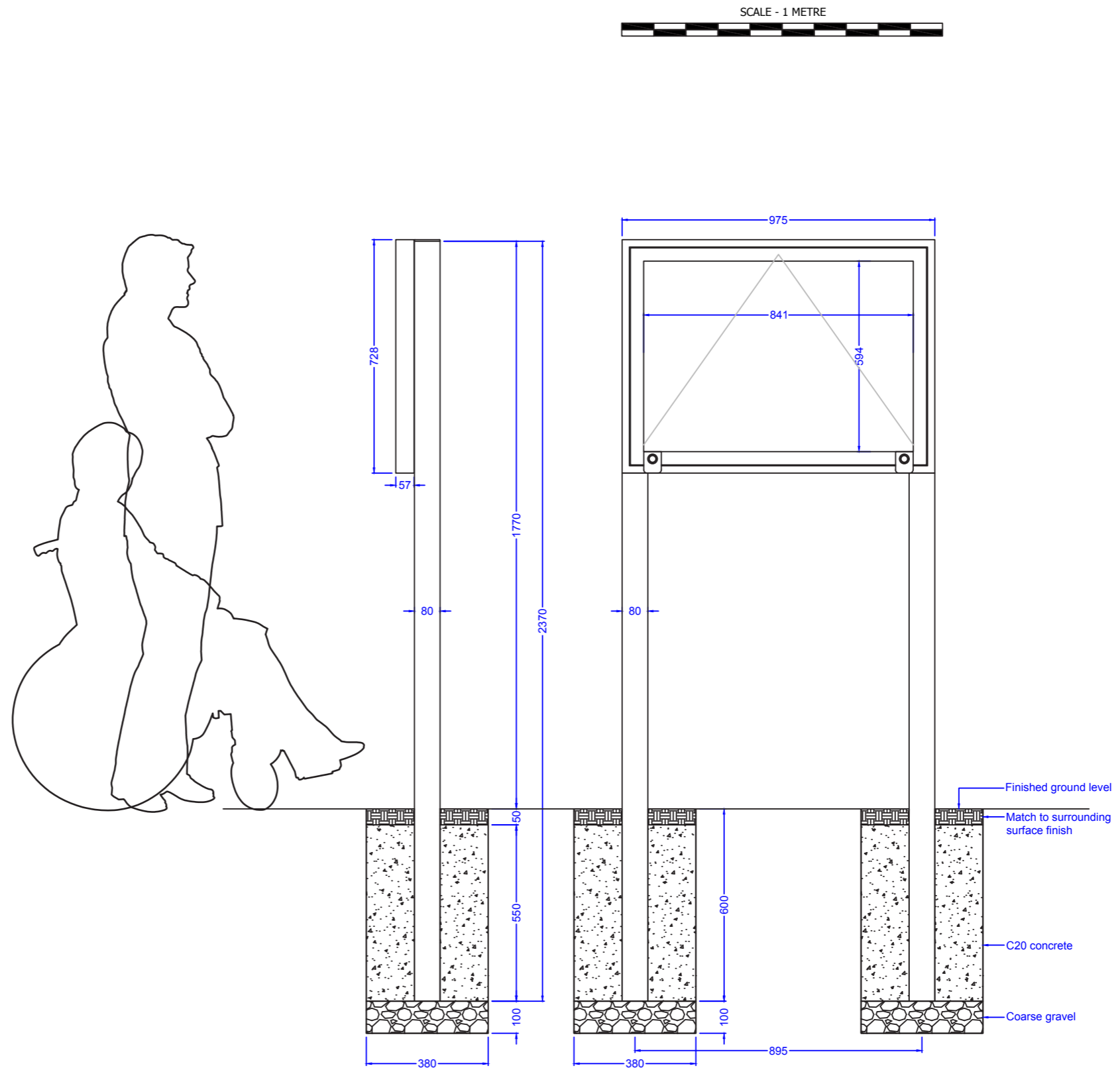

Note: All dimensions are indicative only. Footing details are subject to soil conditions and structural engineers recommendations.

Specification applies to the standard product. Our range of options usually allow us to accommodate any differences you may require. Please contact us and we will be happy to support you in developing this specification to meet your requirements.

*Option delete/ update as appropriate*

**Manufacturer:** Fitzpatrick Woolmer,  
Unit 7 Lakeside Park, Neptune Close,  
Rochester, Kent, ME2 4LT.

**Tel:** 01634 711 771

**Email:** info@fwdp.co.uk

**Metal:** Stainless steel

**Grade:** 304

**Metal:** Aluminium

**Grade:** 1050

**Finish:** Powdercoat to BS EN 12206:2021 Part 1

**Colour:** RAL 9005 Black

**Fixings:** Stainless steel

**Type:** Security

**Weight:** 59kg

**Installation:** Posts extend 600mm below ground level

**Guarantee:** One year manufacturer's warranty

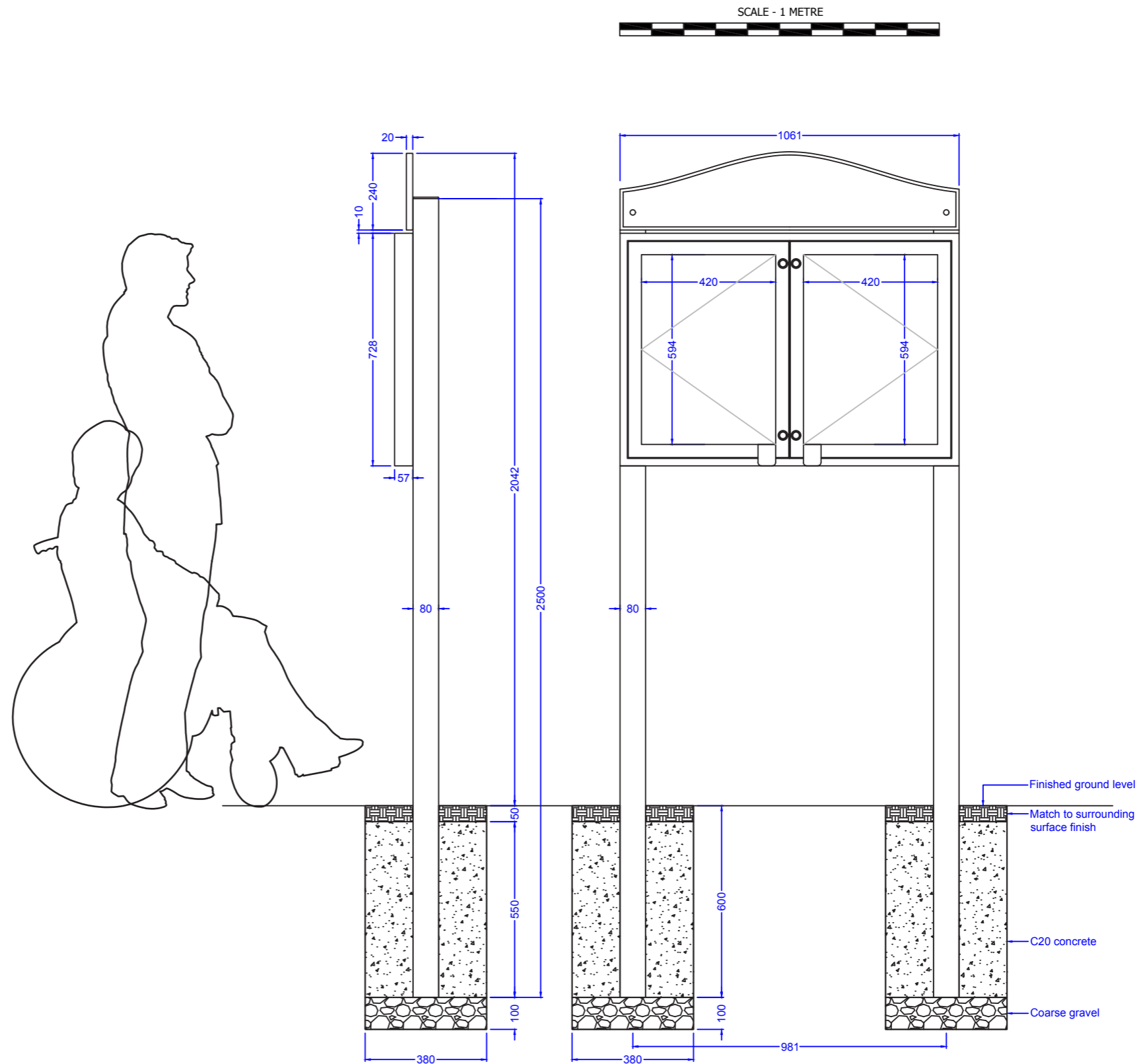

Note: All dimensions are indicative only. Footing details are subject to soil conditions and structural engineers recommendations.

Specification applies to the standard product. Our range of options usually allow us to accommodate any differences you may require. Please contact us and we will be happy to support you in developing this specification to meet your requirements.

Option delete/ update as appropriate

**Manufacturer:** Fitzpatrick Woolmer,  
Unit 7 Lakeside Park, Neptune Close,  
Rochester, Kent, ME2 4LT.

**Tel:** 01634 711 771

**Email:** info@fwdp.co.uk

**Metal:** Stainless steel

**Grade:** 304

**Finish:** Powdercoat to BS EN 12206:2021 Part 1

**Colour:** RAL 9005 Black

**Fixings:** Stainless steel

**Type:** Security

**Weight:** 51kg

**Installation:** Posts extend 600mm below ground level

**Guarantee:** One year manufacturer's warranty

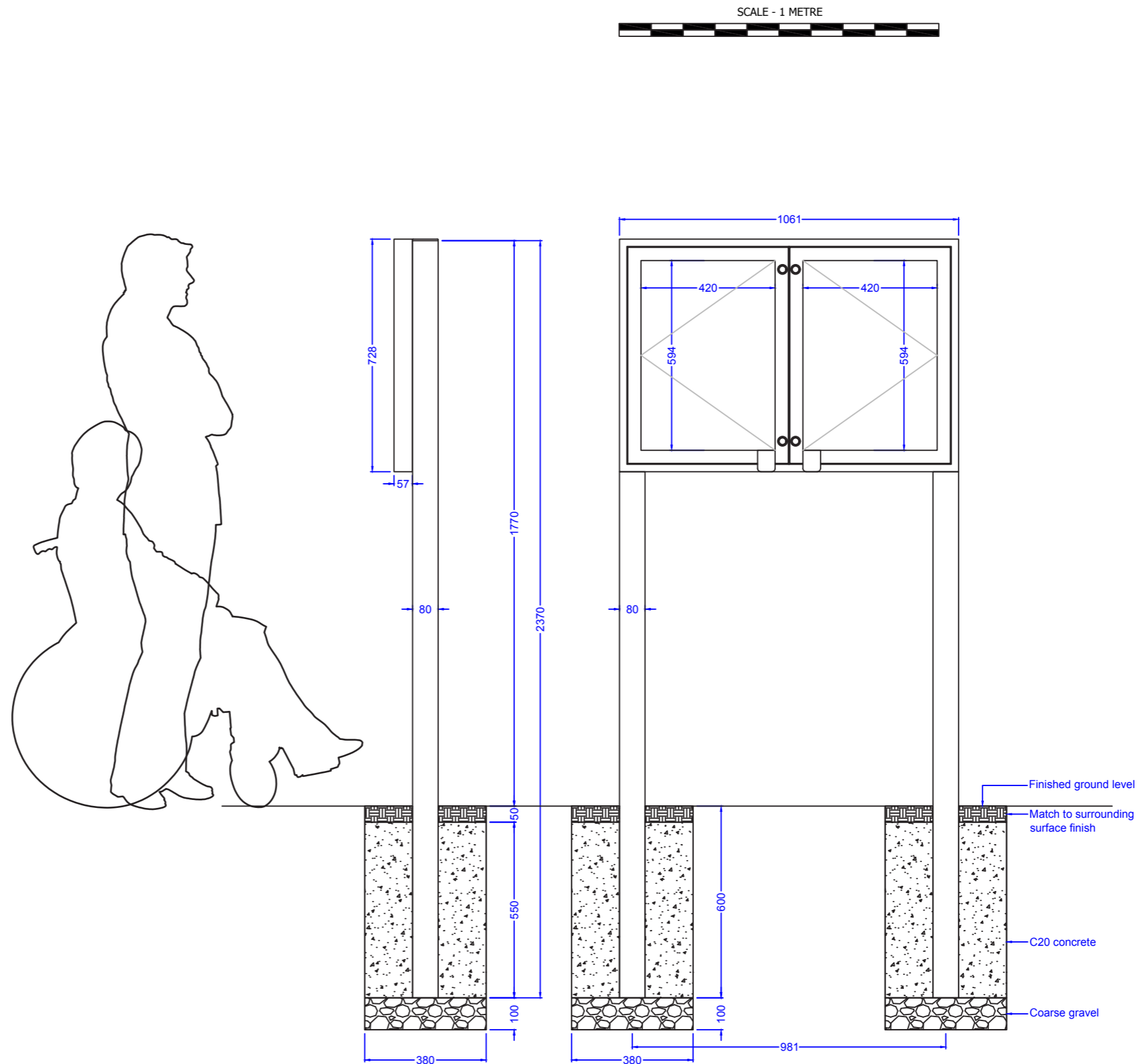

Note: All dimensions are indicative only. Footing details are subject to soil conditions and structural engineers recommendations.

Specification applies to the standard product. Our range of options usually allow us to accommodate any differences you may require. Please contact us and we will be happy to support you in developing this specification to meet your requirements.

Option delete/ update as appropriate

**Manufacturer:** Fitzpatrick Woolmer,  
Unit 7 Lakeside Park, Neptune Close,  
Rochester, Kent, ME2 4LT.

**Tel:** 01634 711 771

**Email:** info@fwdp.co.uk

**Metal:** Stainless steel

**Grade:** 304

**Metal:** Aluminium

**Grade:** 1050

**Finish:** Powdercoat to BS EN 12206:2021 Part 1

**Colour:** RAL 9005 Black

**Fixings:** Stainless steel

**Type:** Security

**Weight:** 35kg

**Installation:** Posts extend 600mm below ground level

**Guarantee:** One year manufacturer's warranty

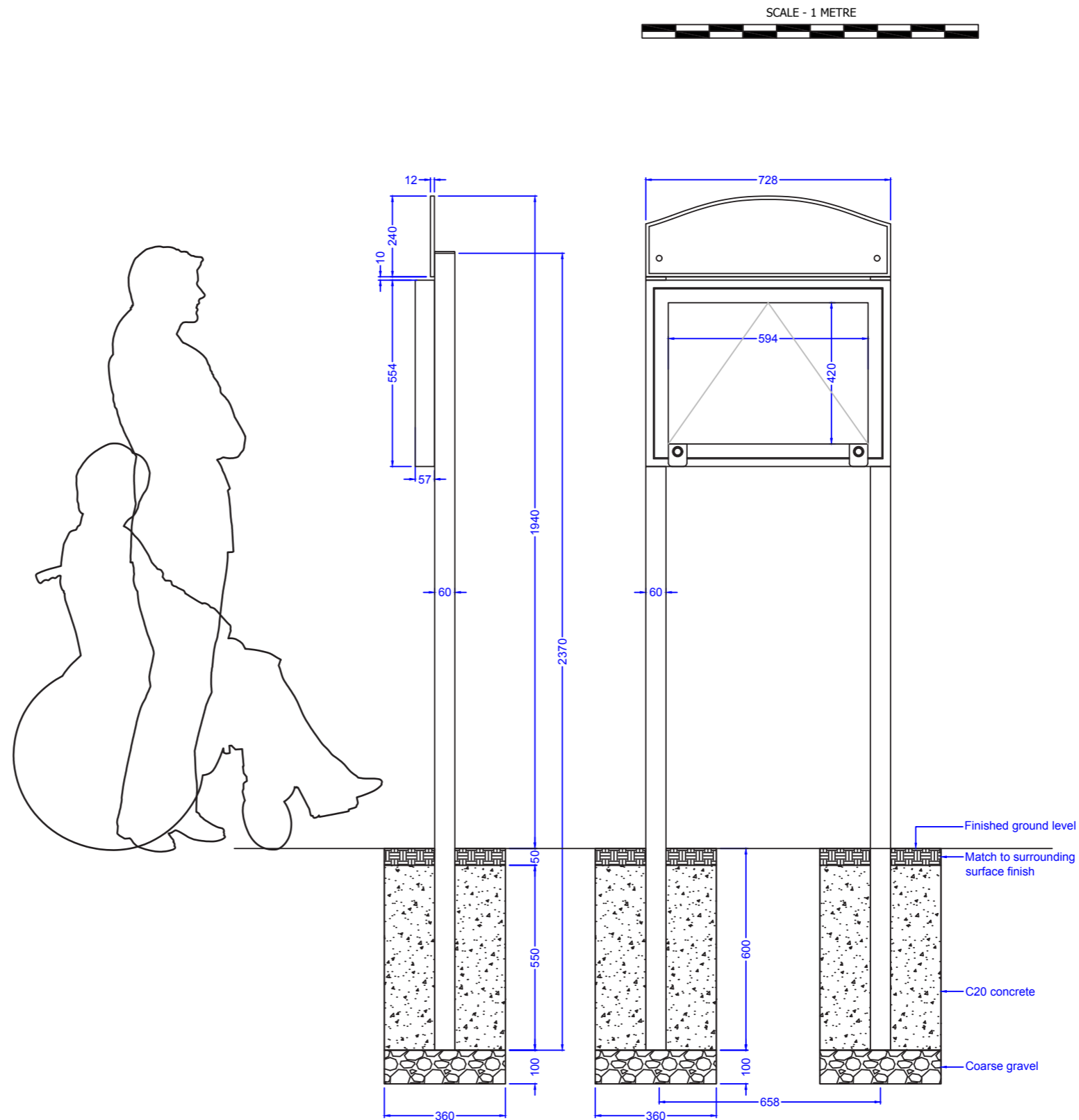

Note: All dimensions are indicative only. Footing details are subject to soil conditions and structural engineers recommendations.

Specification applies to the standard product. Our range of options usually allow us to accommodate any differences you may require. Please contact us and we will be happy to support you in developing this specification to meet your requirements.

Option delete/ update as appropriate

**Manufacturer:** Fitzpatrick Woolmer,  
Unit 7 Lakeside Park, Neptune Close,  
Rochester, Kent, ME2 4LT.

**Tel:** 01634 711 771

**Email:** info@fwdp.co.uk

**Metal:** Stainless steel

**Grade:** 304

**Finish:** Powdercoat to BS EN 12206:2021 Part 1

**Colour:** RAL 9005 Black

**Fixings:** Stainless steel

**Type:** Security

**Weight:** 30kg

**Installation:** Posts extend 600mm below ground level

**Guarantee:** One year manufacturer's warranty

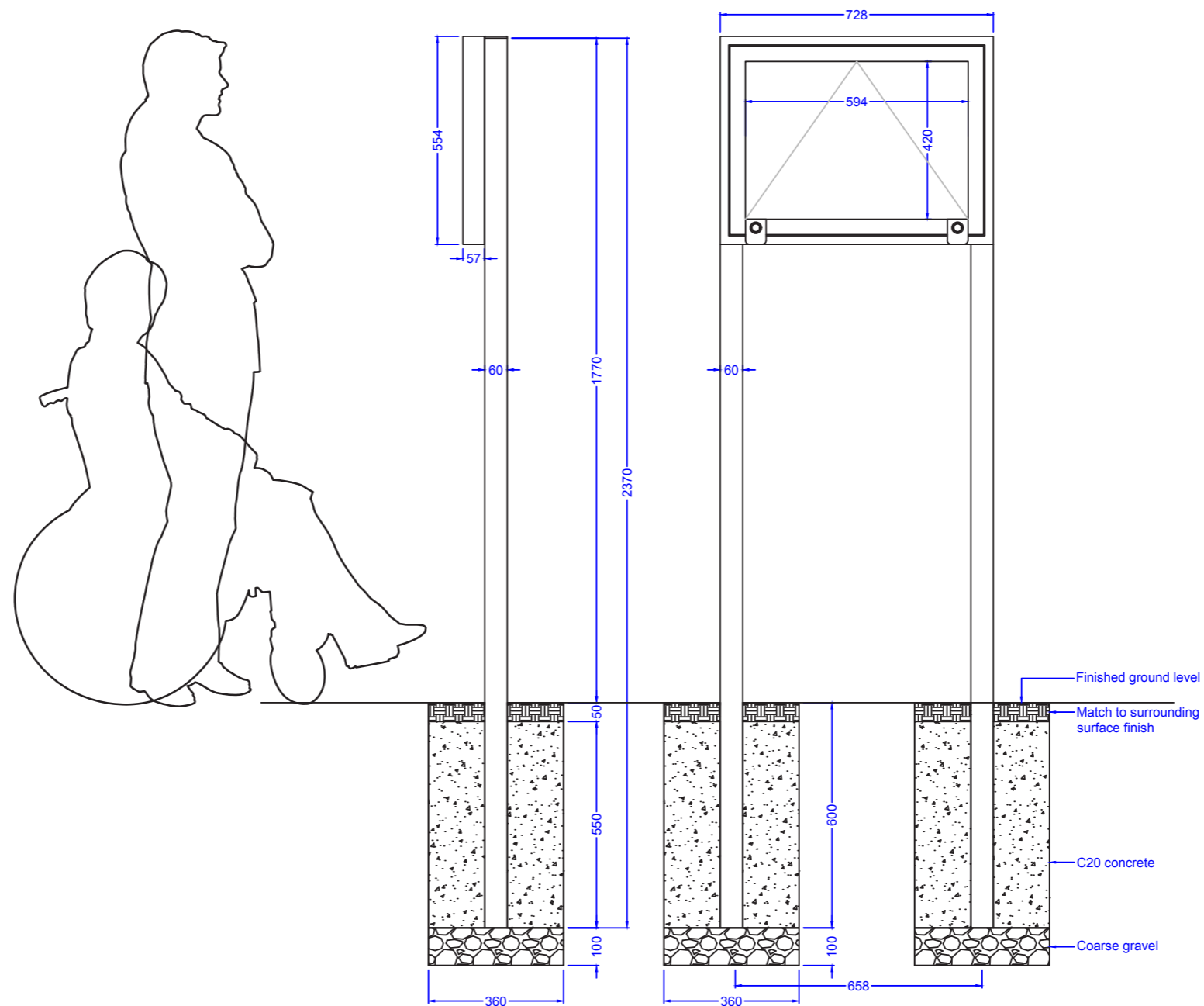
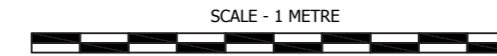

Note: All dimensions are indicative only. Footing details are subject to soil conditions and structural engineers recommendations.