

 **1+**  
 **1**  
 **0,94m**  

 1 = 2,31m  
 2 = 0,33m  
 3 = 1,58m



Physical inclusion  
Sensory inclusion  
Cognitive inclusion

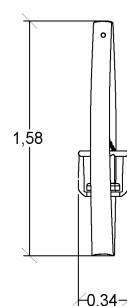
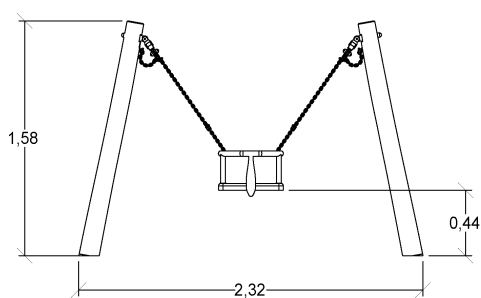

Play value : **2**

meeting



x1

swinging



x1

## Installation of equipment

**IMPORTANT:** It is essential to refer to the installation instructions for information on the size of the safety areas.



———— Impact area (minimum normative surface)

— · — · — · Free space

 Zone d'Impact Sol souple  
Impact Area Wetpour  
Area de Impacto  
Fallraum bei synthetischem Fallschutz

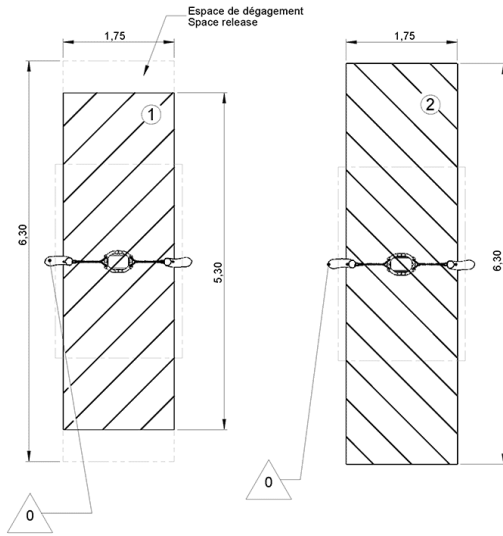
 Zone d'Impact Sol fluent  
Impact Area Loose particle material  
Arenero  
Fallraum bei losem Bodenmaterial



	
1	0,94m
	9,5m <sup>2</sup>



2



01h00



0.4m<sup>3</sup>



9.5m<sup>2</sup>



63kg



27kg

EN  
1176

## Environmental Indicators

Repairability



9,49 / 10

Carbon footprint



-0,73 KgCO<sub>2</sub>/Kg

Recyclable materials



96,71%

ECO materials: 86%

Recycled materials



0,15%

Bio-sourced materials



86,31%