



4+



10



1,2m



1 = 7,4m  
2 = 0,69m  
3 = 2,62m



Physical inclusion  
Sensory inclusion  
Cognitive inclusion

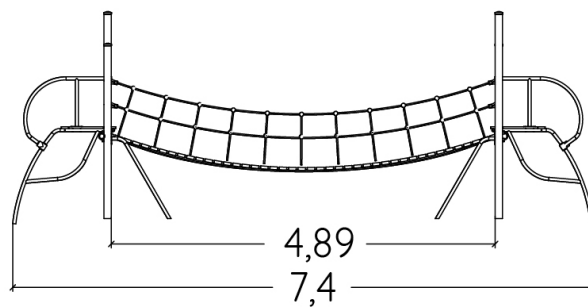
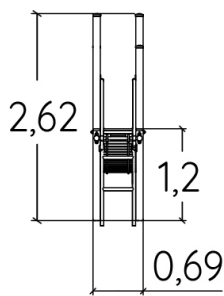
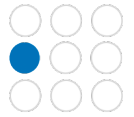

Play value : **8**

role play



x2

meeting



x2

balancing



x1

climbing



x2

getting across



x1

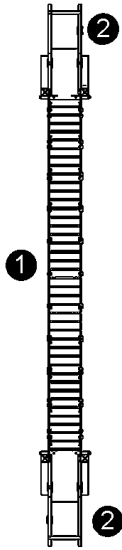

## Components



- ① Flexible bridge L: 5m
- ② The walkway access

## Installation of equipment

**IMPORTANT:** It is essential to refer to the installation instructions for information on the size of the safety areas.

-  Impact area (minimum normative surface)
-  Free space

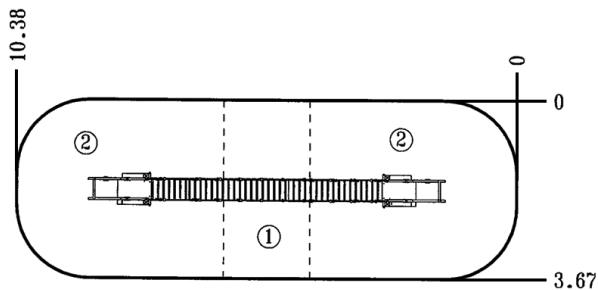

1	1,00m	7m <sup>2</sup>
2	1,20m	30m <sup>2</sup>



2



06h30



0.5m<sup>3</sup>



37m<sup>2</sup>



247kg



69kg

EN  
1176