

# rowing boat

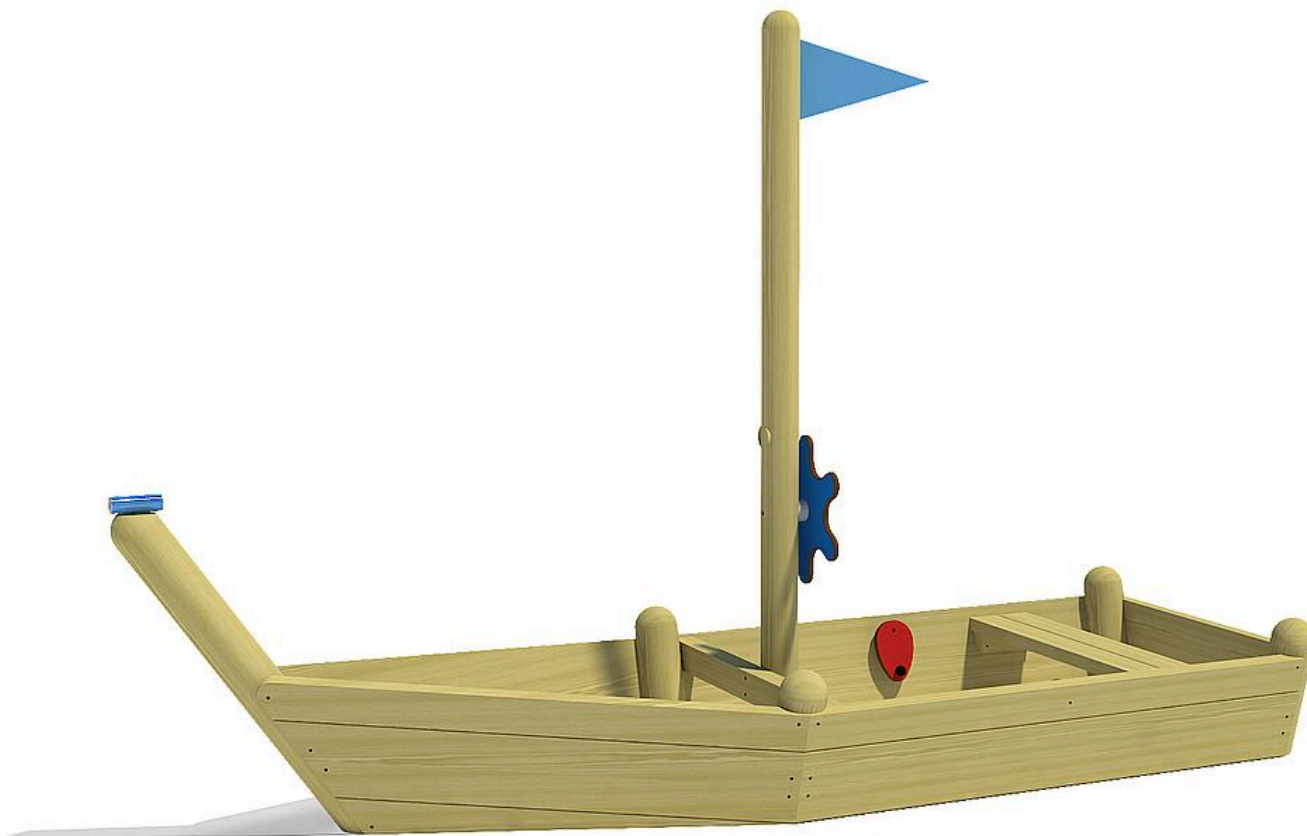

Age indication



Imagination



Social skills

## Scope of delivery

2x seat boards: softwood  
 1x steering wheel: high pressure laminate (HPL)  
 1x mast: softwood  
 2x rudder: PE  
 1x telescope: plastic  
 1x flag: tent tarpaulin  
 wooden structure: softwood

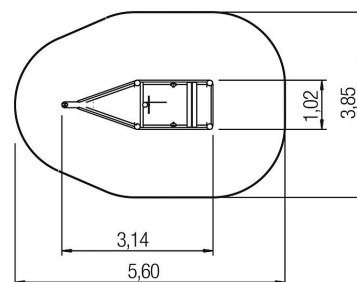
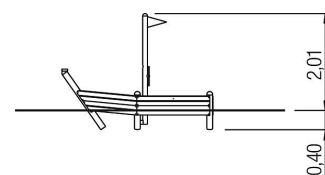

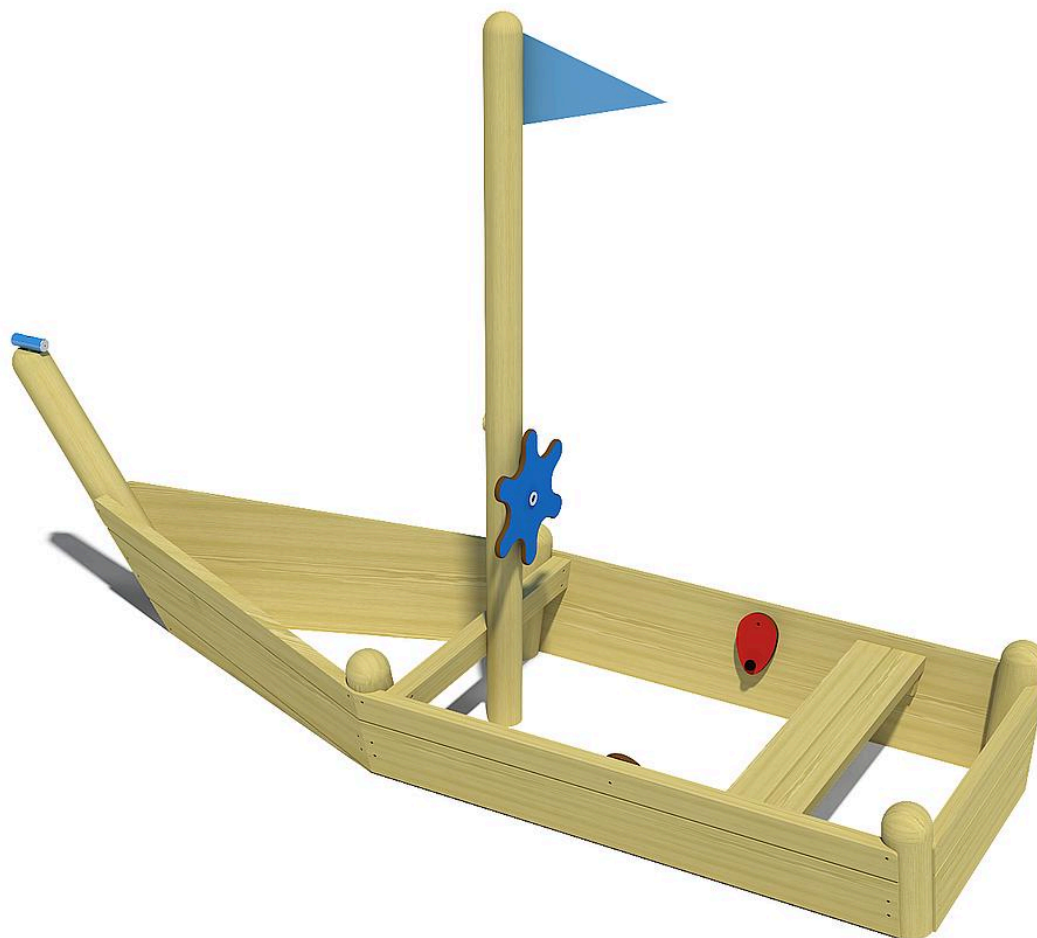

## Technical data

	Material	SW pi
	Minimum space	5,60x3,85x2,40 m
	Impact protection net	-
	Free falling height	60 cm
	Ground constitution GE/NL/B	at least lawn
	Ground constitution all except GE/NL/B	at least lawn
	Largest section	100x50x14 cm
	Heaviest section	40 kg
	Certificate	RAL
	Tested according to standard	-

## Installation information

	Foundations	-
	Fundamentlevel	-
	Assembly	2 persons/2 h



# 5 59 113 0 rowing boat

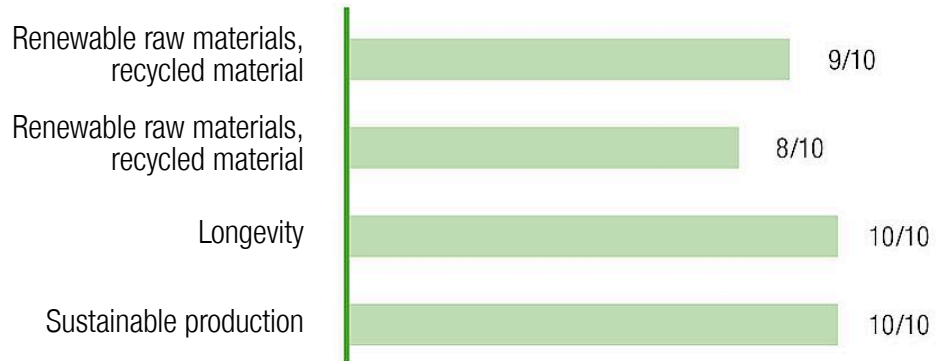

**CO<sub>2</sub> emissions of the product**

**92,7 kg**

**Material share of renewable raw materials**

**94%**

**Recyclate content**

**1%**

Circularity score

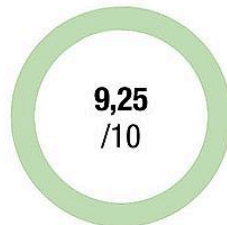

Weighted emission factor of the product\*



**Disclaimer:**

This dashboard for the circularity index of the 'Circular Product' certification was generated automatically and is based on the corresponding certification of eibe Produktion + Vertrieb GmbH & Co KG, Industriestraße 1, 97285 Röttingen, which was issued on 16 May 2024 by the Gesellschaft für Klimaschutz München GmbH (GKM GmbH) on the basis of the example product Albion play unit from the eibe unique® product line. eibe Produktion + Vertrieb GmbH & Co KG is liable for the accuracy of the contents. The award criteria of the private-law certification 'Circular Product' of GKM GmbH can be viewed at [gesellschaft-klimaschutz.de/zertifizierung/zirkularitaet/](https://gesellschaft-klimaschutz.de/zertifizierung/zirkularitaet/).

\* The CO<sub>2</sub>e emissions of the materials used in the product are taken into account. The emissions that arise during the production process are allocated to the product on a pro-rata basis.

created on: 14 August 2024