

active-station bicycle



Age indication



Fitness



Fine motor skills



Balance

Scope of delivery



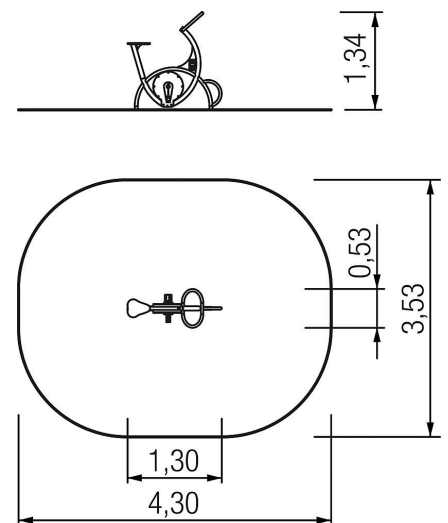





1x active-station: stainless steel, HDPE



active-station bicycle



Technical data

| | | |
|---|---|--------------------------|
|  | Material | Stainless steel, HDPE |
|  | Minimum space | 3,53x4,30x2,97 m |
|  | Impact protection net | 2,0 m ² |
|  | Free falling height | 77 cm |
|  | Ground constitution GE/NL/B | impact-attenuating tiles |
|  | Ground constitution all except GE/NL/B | impact-attenuating tiles |
|  | Size | 1,30x0,53x1,34 m |
|  | mx. number of users | 1 |

Installation information

| | | |
|---|----------------|-----------------|
|  | Foundations | 1x CF |
|  | Fundamentlevel | ET 0 |
|  | Assembly | 2 persons/2,5 h |