

5 56 082 0

Spinning mushroom Kerberos Ø 0,95 m



Age indication



Fitness



Social skills



Balance



Speed

Scope of delivery

1x post: powder-coated steel

1x carousel structure: powder-coated steel

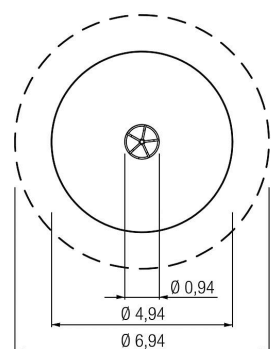
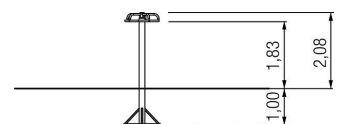

5 56 082 0



Spinning mushroom Kerberos Ø 0,95 m



Technical data

	Material	Steel powder.
	Minimum space	Ø 4,94x3,88 m
	Impact protection net	20,0 m ²
	Free falling height	100 cm
	Ground constitution GE/NL/B	at least top soil
	Ground constitution all except GE/NL/B	at least top soil
	Size	Ø 0,94x2,08 m
	Largest section	308 cm
	Heaviest section	85 kg
	mx. number of users	4

Installation information

	Foundations	1x CF
	Fundamentlevel	ET 1000
	CF concrete	0,50 m ³

Legend: PF=prefabricated foundation, CF=concrete foundation, ET=burial depth, GFRP=glass-fibre reinforced plastic, VA=stainless steel, PH=platform height