



FUSILIER™ NOTICE BOARD

Our **Fusilier™** notice boards are built for demanding public environments. Robust and weather-resistant, they offer long-lasting durability with a sleek, professional finish. Available in single or double door options, they feature lockable doors for secure, tamper-resistant display.

Designed for practicality, they're low-maintenance and easy to update. Their clean lines and modern aesthetic make them ideal for civic and commercial settings, while their resilient construction ensures reliable performance in all conditions, year after year.

Product features

- Stainless steel construction
- Can be supplied with or without a header board
- Robust stainless steel locks
- Gas struts to support doors when open
- Tough 4mm clear polycarbonate window
- Magnetic back board – magnets included
- Vent holes to minimise condensation
- Powdercoat finish to standard colour
- Standard sizes A2, A1 and A0
- 1 year manufacturer's warranty

Specification applies to the standard product. Our range of options usually allow us to accommodate any differences you may require. Please contact us and we will be happy to support you in developing this specification to meet your requirements.

Option delete/ update as appropriate

Manufacturer: Fitzpatrick Woolmer,
Unit 7 Lakeside Park, Neptune Close,
Rochester, Kent, ME2 4LT.

Tel: 01634 711 771

Email: info@fwdp.co.uk

Metal: Stainless steel

Grade: 304

Metal: Aluminium

Grade: 1050

Finish: Powdercoat to BS EN 12206:2021 Part 1

Colour: RAL 9005 Black

Fixings: Stainless steel

Type: Security

Weight: 73kg

Installation: Posts extend 600mm below ground level

Guarantee: One year manufacturer's warranty

Note:
All dimensions are indicative only.
Footing details are subject to
soil conditions and structural
engineers recommendations.

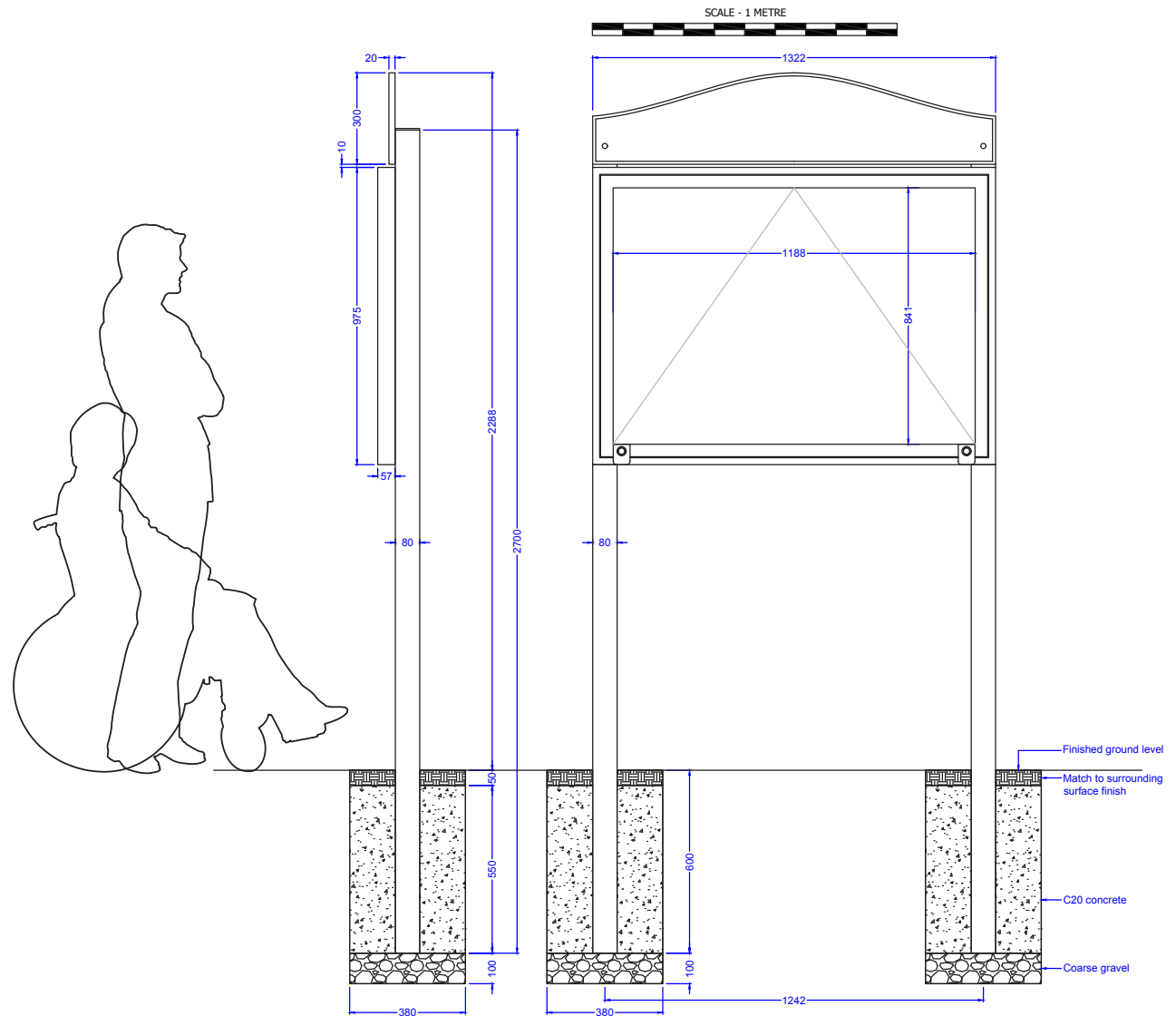

Specification applies to the standard product. Our range of options usually allow us to accommodate any differences you may require. Please contact us and we will be happy to support you in developing this specification to meet your requirements.

Option delete/ update as appropriate

Manufacturer: Fitzpatrick Woolmer,
Unit 7 Lakeside Park, Neptune Close,
Rochester, Kent, ME2 4LT.

Tel: 01634 711 771

Email: info@fwdp.co.uk

Metal: Stainless steel

Grade: 304

Metal: Aluminium

Grade: 1050

Finish: Powdercoat to BS EN 12206:2021 Part 1

Colour: RAL 9005 Black

Fixings: Stainless steel

Type: Security

Weight: 80kg

Installation: Posts extend 600mm below ground level

Guarantee: One year manufacturer's warranty

Note:
All dimensions are indicative only.
Footing details are subject to
soil conditions and structural
engineers recommendations.

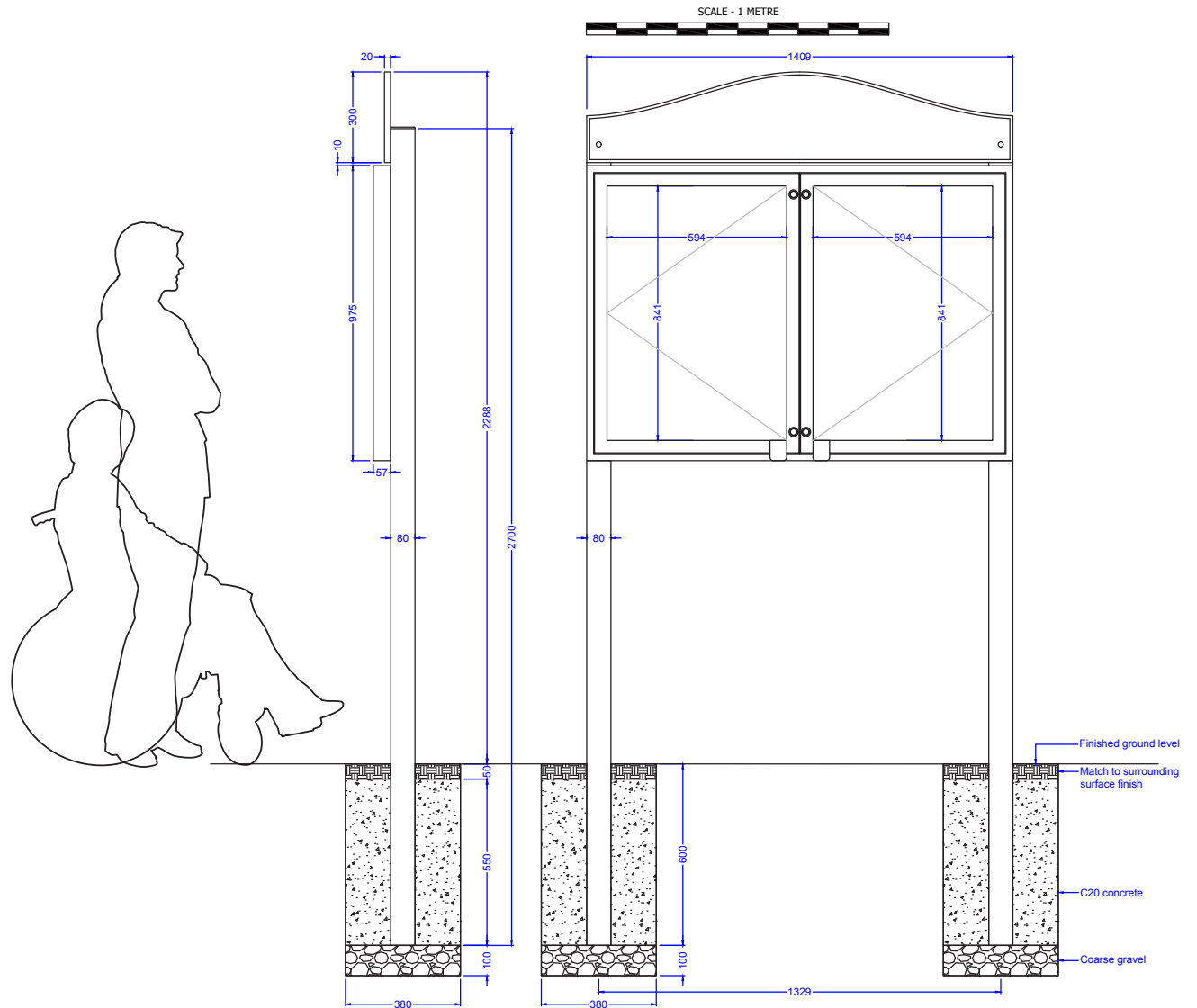

Specification applies to the standard product.
Our range of options usually allow us to accommodate any differences you may require.
Please contact us and we will be happy to support you in developing this specification to meet your requirements.

Option delete/ update as appropriate

Manufacturer: Fitzpatrick Woolmer,
Unit 7 Lakeside Park, Neptune Close,
Rochester, Kent, ME2 4LT.

Tel: 01634 711 771

Email: info@fwdp.co.uk

Metal: Stainless steel

Grade: 304

Finish: Powdercoat to BS EN 12206:2021 Part 1

Colour: RAL 9005 Black

Fixings: Stainless steel

Type: Security

Weight: 46kg

Installation: Posts extend 600mm below ground level

Guarantee: One year manufacturer's warranty

Note:
All dimensions are indicative only.
Footing details are subject to soil conditions and structural engineers recommendations.

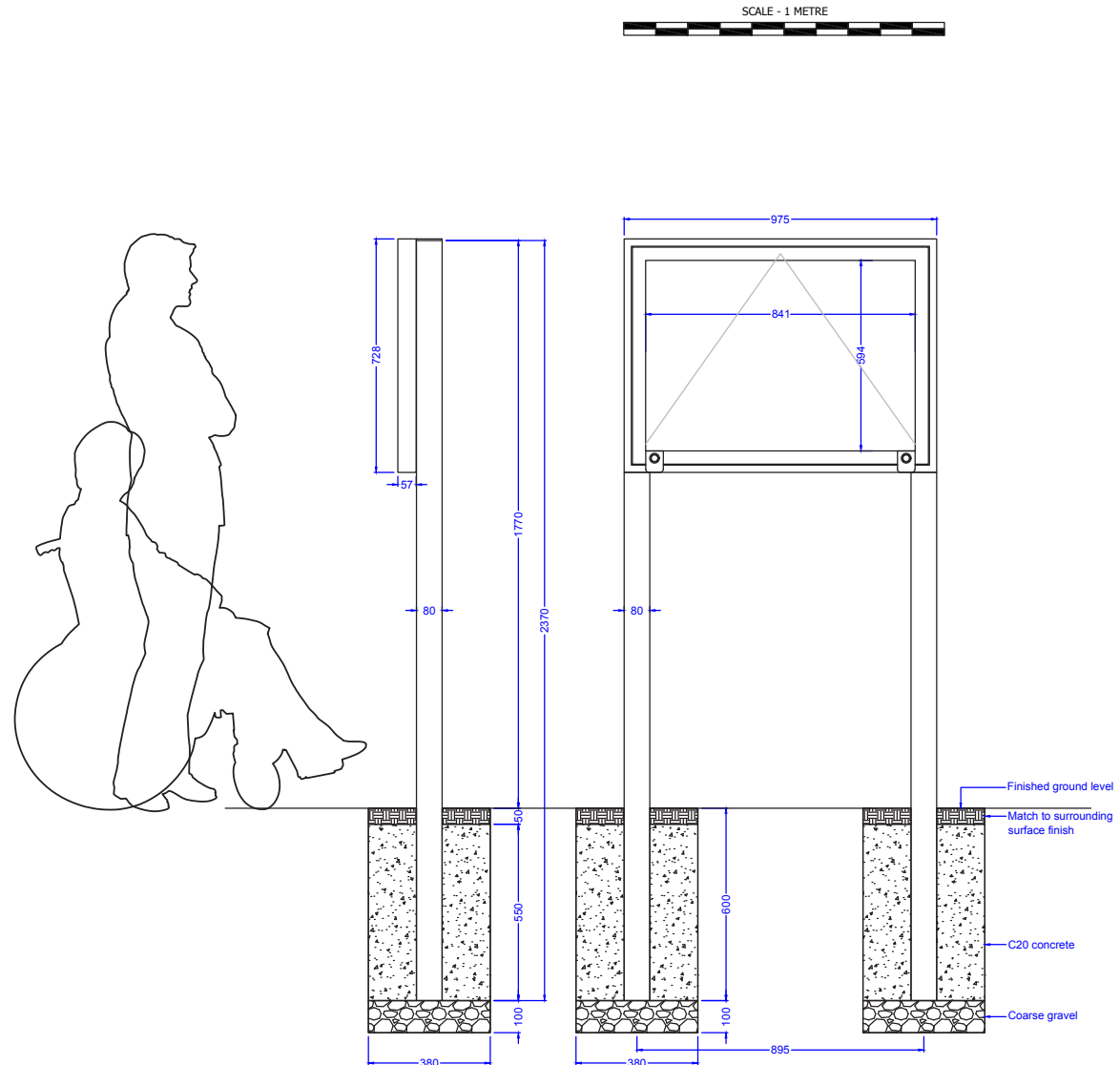

Specification applies to the standard product. Our range of options usually allow us to accommodate any differences you may require. Please contact us and we will be happy to support you in developing this specification to meet your requirements.

Option delete/ update as appropriate

Manufacturer: Fitzpatrick Woolmer,
Unit 7 Lakeside Park, Neptune Close,
Rochester, Kent, ME2 4LT.

Tel: 01634 711 771

Email: info@fwdp.co.uk

Metal: Stainless steel

Grade: 304

Metal: Aluminium

Grade: 1050

Finish: Powdercoat to BS EN 12206:2021 Part 1

Colour: RAL 9005 Black

Fixings: Stainless steel

Type: Security

Weight: 53kg

Installation: Posts extend 600mm below ground level

Guarantee: One year manufacturer's warranty

Note:
All dimensions are indicative only.
Footing details are subject to
soil conditions and structural
engineers recommendations.

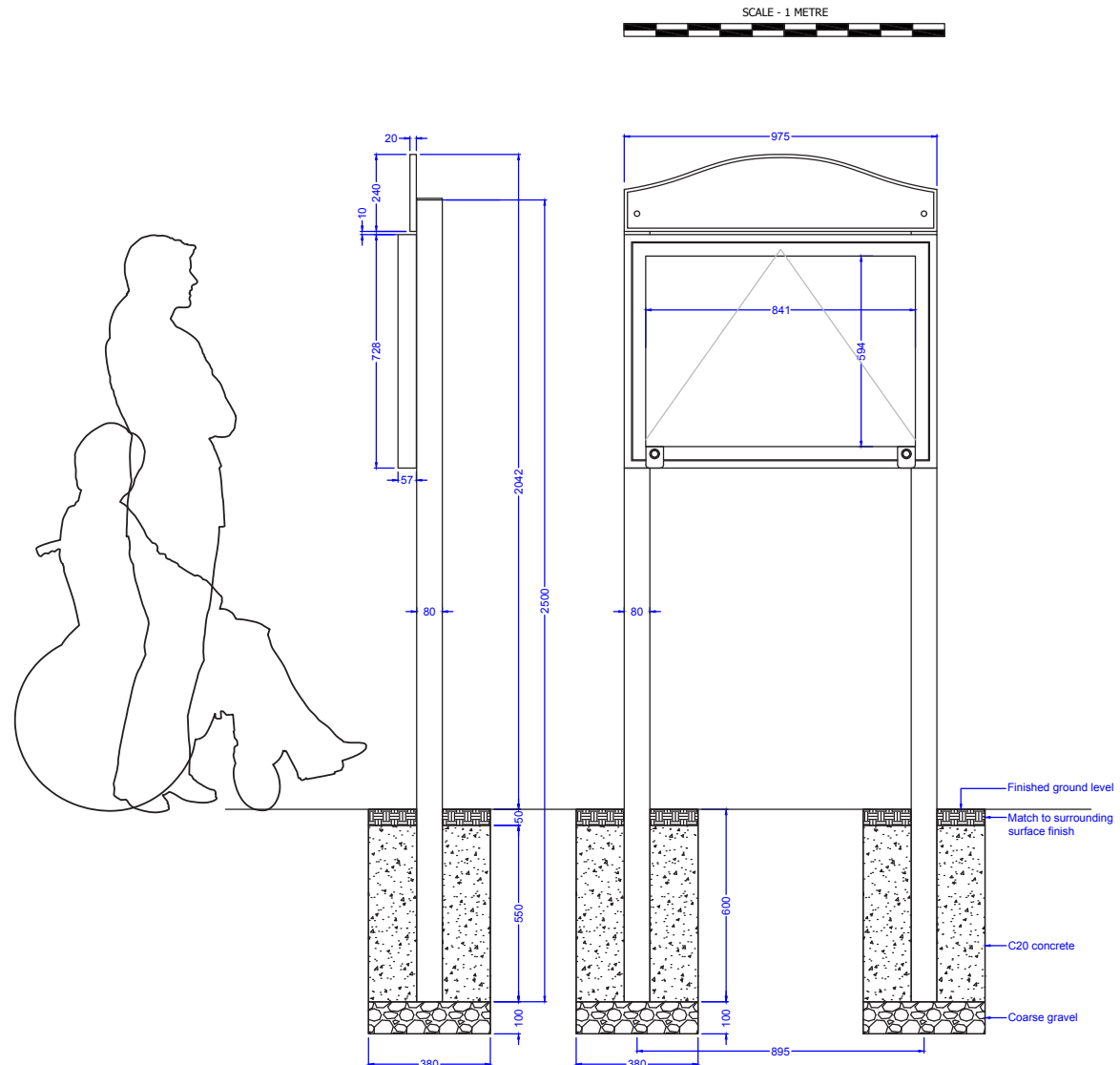

Specification applies to the standard product. Our range of options usually allow us to accommodate any differences you may require. Please contact us and we will be happy to support you in developing this specification to meet your requirements.

Option delete/ update as appropriate

Manufacturer: Fitzpatrick Woolmer,
Unit 7 Lakeside Park, Neptune Close,
Rochester, Kent, ME2 4LT.
Tel: 01634 711 771
Email: info@fwdp.co.uk

Metal: Stainless steel

Grade: 304

Finish: Powdercoat to BS EN 12206:2021 Part 1

Colour: RAL 9005 Black

Fixings: Stainless steel

Type: Security

Weight: 51kg

Installation: Posts extend 600mm below ground level

Guarantee: One year manufacturer's warranty

Note:
All dimensions are indicative only.
Footing details are subject to
soil conditions and structural
engineers recommendations.

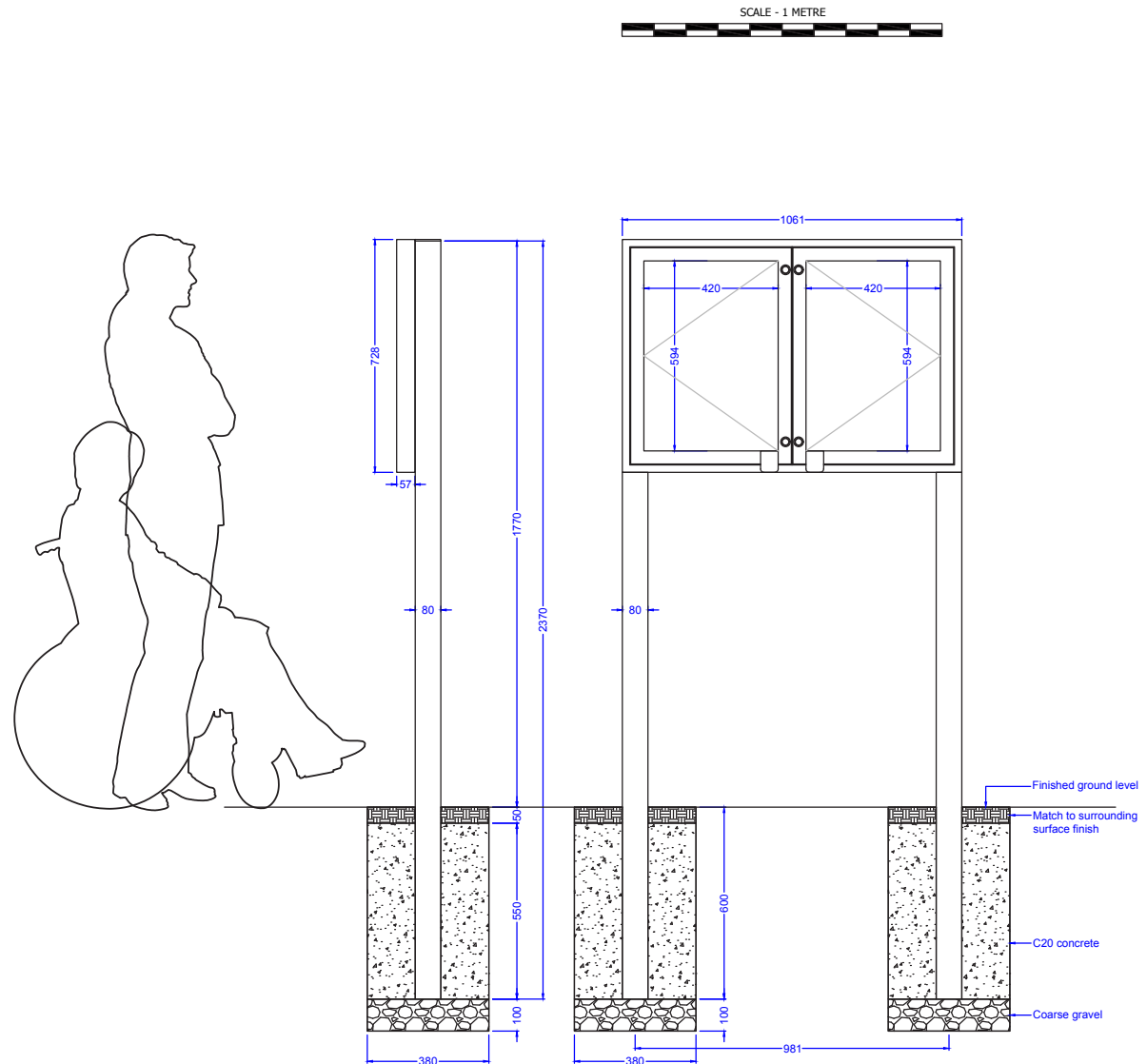

Specification applies to the standard product.
 Our range of options usually allow us to accommodate any differences you may require.
 Please contact us and we will be happy to support you in developing this specification to meet your requirements.

Option delete/ update as appropriate

Manufacturer: Fitzpatrick Woolmer,
 Unit 7 Lakeside Park, Neptune Close,
 Rochester, Kent, ME2 4LT.
Tel: 01634 711 771
Email: info@fwdp.co.uk

Metal: Stainless steel

Grade: 304

Finish: Powdercoat to BS EN 12206:2021 Part 1

Colour: RAL 9005 Black

Fixings: Stainless steel

Type: Security

Weight: 30kg

Installation: Posts extend 600mm below ground level

Guarantee: One year manufacturer's warranty

SCALE - 1 METRE

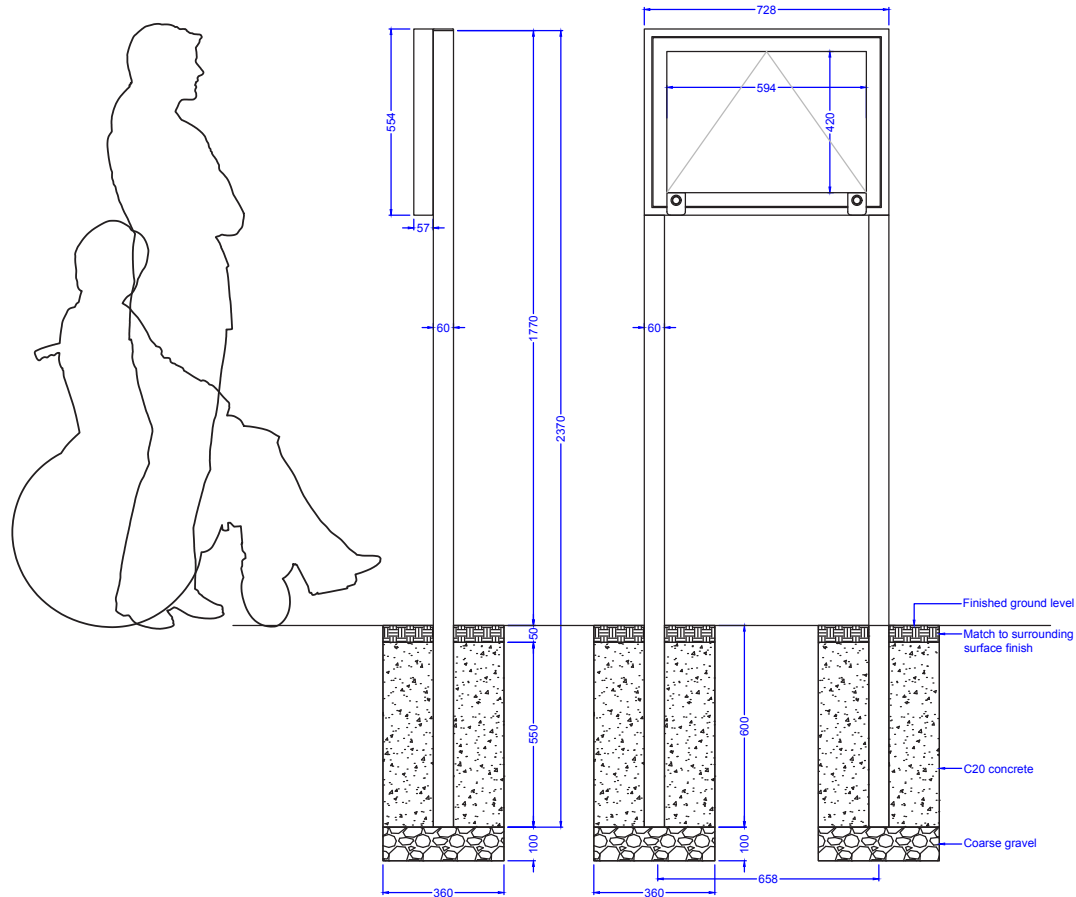

Note:
 All dimensions are indicative only.
 Fixing details are subject to
 soil conditions and structural
 engineers recommendations.

Specification applies to the standard product. Our range of options usually allow us to accommodate any differences you may require. Please contact us and we will be happy to support you in developing this specification to meet your requirements.

Option delete/ update as appropriate

Manufacturer: Fitzpatrick Woolmer,
Unit 7 Lakeside Park, Neptune Close,
Rochester, Kent, ME2 4LT.

Tel: 01634 711 771

Email: info@fwdp.co.uk

Metal: Stainless steel

Grade: 304

Metal: Aluminium

Grade: 1050

Finish: Powdercoat to BS EN 12206:2021 Part 1

Colour: RAL 9005 Black

Fixings: Stainless steel

Type: Security

Weight: 35kg

Installation: Posts extend 600mm below ground level

Guarantee: One year manufacturer's warranty

Note:
All dimensions are indicative only.
Footing details are subject to
soil conditions and structural
engineers recommendations.

