

5 56 069 0

# Stand-up roundabout Uranus Ø 1,15 m



Age indication



Speed



Balance



Senses



Social skills

## Scope of delivery

1x mounting panel: stainless steel

1x bearing: Ball/conical roll bearing

1x bottom plate Ø 115 cm: stainless steel, rubber

base structure: stainless steel

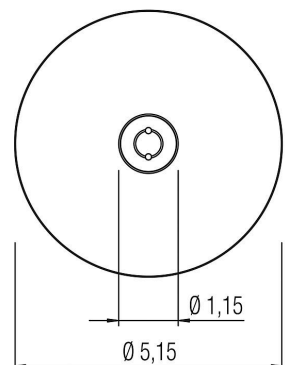
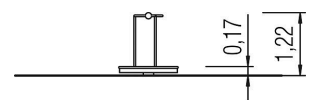





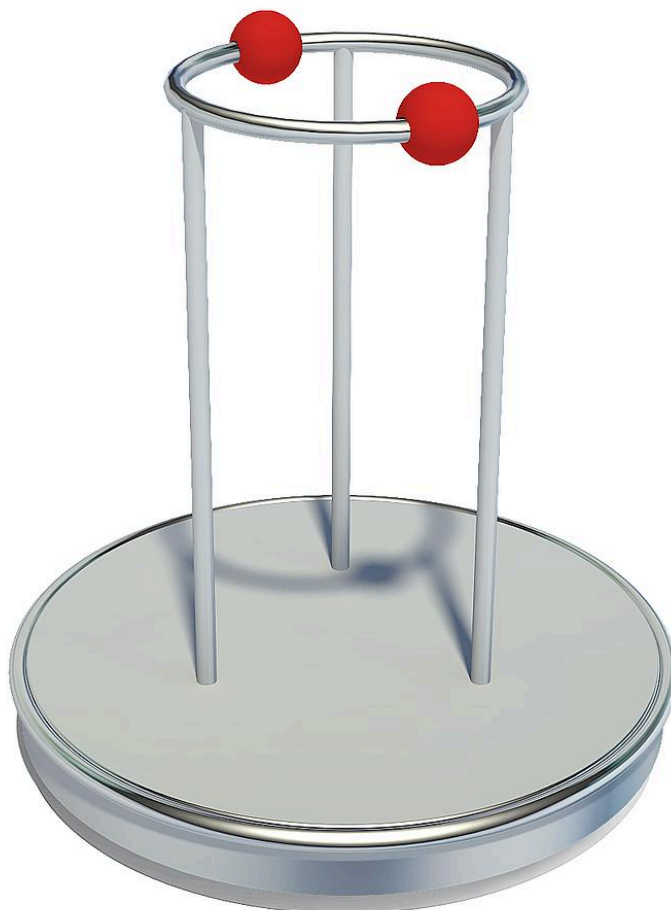



5 56 069 0



# Stand-up roundabout Uranus Ø 1,15 m



## Technical data

	Material	Stainless steel
	Minimum space	Ø 5,15x3,30 m
	Impact protection net	21,0 m <sup>2</sup>
	Free falling height	17 cm
	Ground constitution GE/NL/B	at least top soil
	Ground constitution all except GE/NL/B	at least top soil
	Size	Ø 1,15x1,21 m
	Largest section	Ø 115x122 cm
	Heaviest section	25 kg
	Certificate	-
	Tested according to standard	-

## Installation information

	Foundations	1x CF
	Fundamentlevel	ET 600
	Assembly	2 persons/2 h

Legend: PF=prefabricated foundation, CF=concrete foundation, ET=burial depth, GFRP=glass-fibre reinforced plastic, VA=stainless steel, PH=platform height