

design  
make  
play

# SutcliffePlay

Waggon Lane  
Upton Pontefract  
West Yorkshire WF9 1JS  
Telephone +44 (0) 1977 653200  
Facsimile +44 (0) 1977 653222  
info@sutcliffeplay.co.uk  
www.sutcliffeplay.co.uk



## Installation Instructions

### PZU1000

# PZU1000

## Playzone Unit Installation Instructions

design  
make  
play  
**SutcliffePlay**

1. Check using the Parts List that none of the components are missing.
2. Plan the final position of the play equipment ensuring there is sufficient space.
3. Sort and identify parts before assembly. Each leg is numbered to correspond with the foundation plan.
4. Excavate the foundation holes in accordance with the plan.
5. Position 2 x 300mm long spragging irons into the holes provided in each post upright and stand in the foundation holes. Assemble the decks at the positions marked on the posts. Do not tighten the fixing bolts until all the activities have been assembled.
6. Assemble the activities onto the posts as per the diagrams in this document. Leave fixing bolts loose until all the activities have been assembled. Ground fixed activities need 200mm spragging irons positioned through their holes.
7. Assemble the plastic slides as per the diagrams in this document.
8. When all activities have been assembled, tighten all the fixings, attach nut covers where necessary, ensure the unit is level and the posts are vertical.
9. Fill the foundation holes to the required depth with concrete.
10. Do not allow the equipment to be used until the concrete has set (2 - 3 days) and the required safety surfacing has been installed.
11. Tighten all fixing bolts.
12. Follow the maintenance instructions supplied.

### NB:

1. Slide runouts should be inclined downwards by approximately 2 degrees for drainage purposes.
2. During installation care must be taken to prevent hazards to children.
3. Extra care should be taken if conditions are abnormal.

# PZU1000

Playzone Unit  
Parts List

design  
make  
play  
**SutcliffePlay**

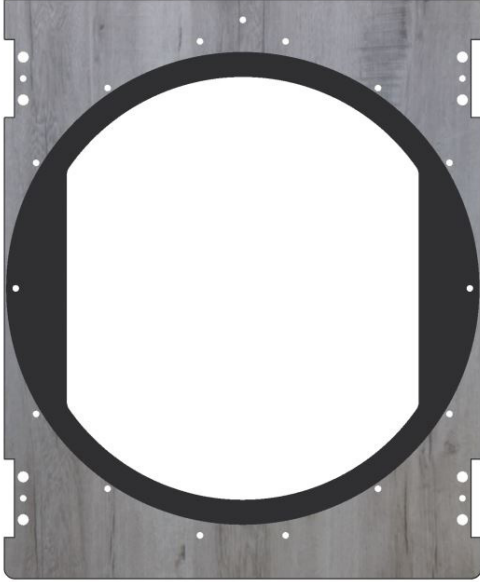

DZA709 x1



DZA724 x2

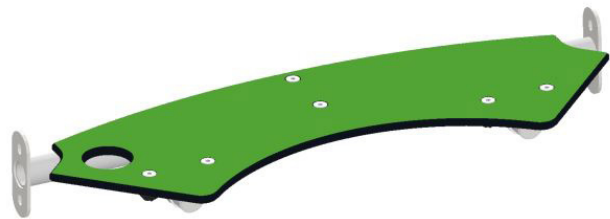

PZC001 x3



PZA050 x1



PZC015 x1

# PZU1000

Playzone Unit  
Parts List

design  
make  
play  
**SutcliffePlay**



PZC008 x1



PZC009 x1

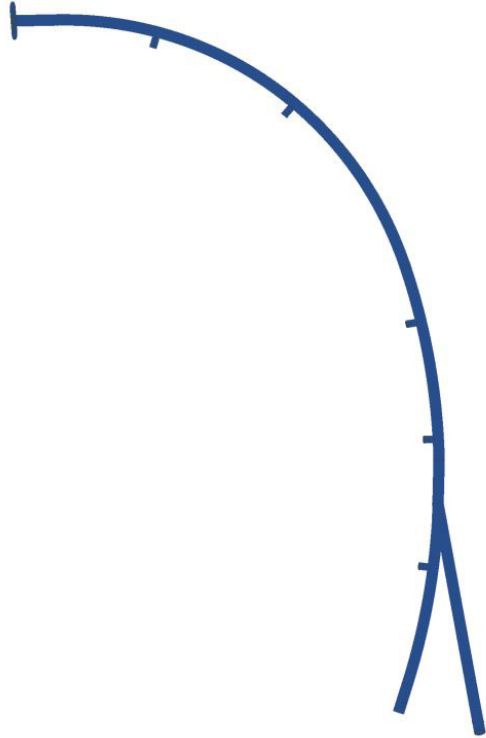

PZC007 x1

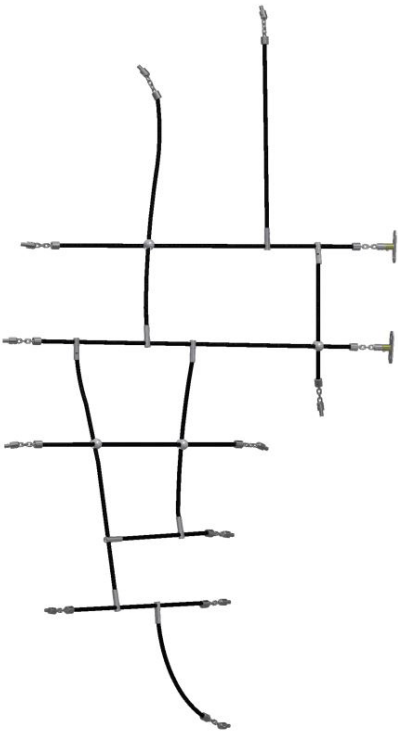

PZC012 x1



PZC013 x1



PZC010 x1

# PZU1000

Playzone Unit  
Parts List

design  
make  
play  
**SutcliffePlay**

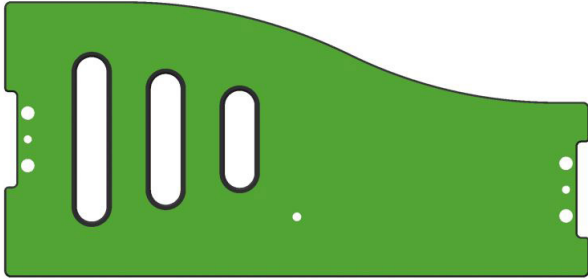

PZC016 x1

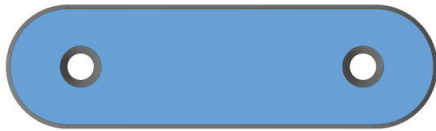

PZC017 x1

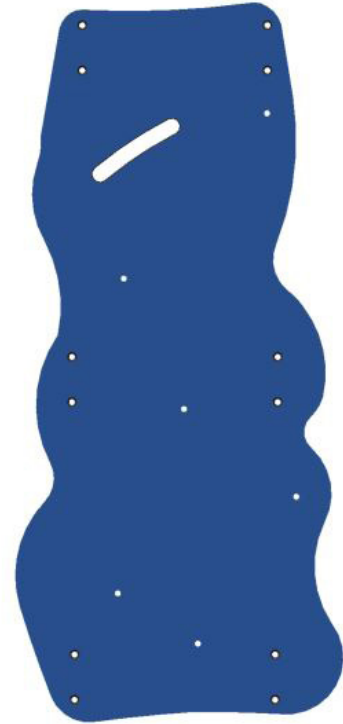

PZC018 x1



Set of Posts  
x4

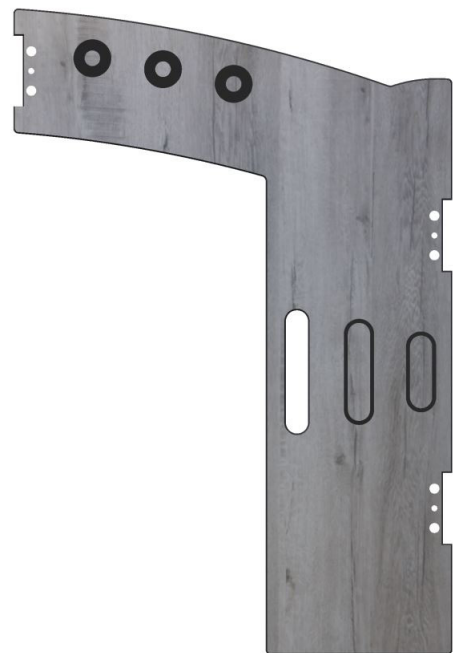

PZC019 x1

# PZU1000

Playzone Unit  
Assembly

design  
make  
play  
**SutcliffePlay**

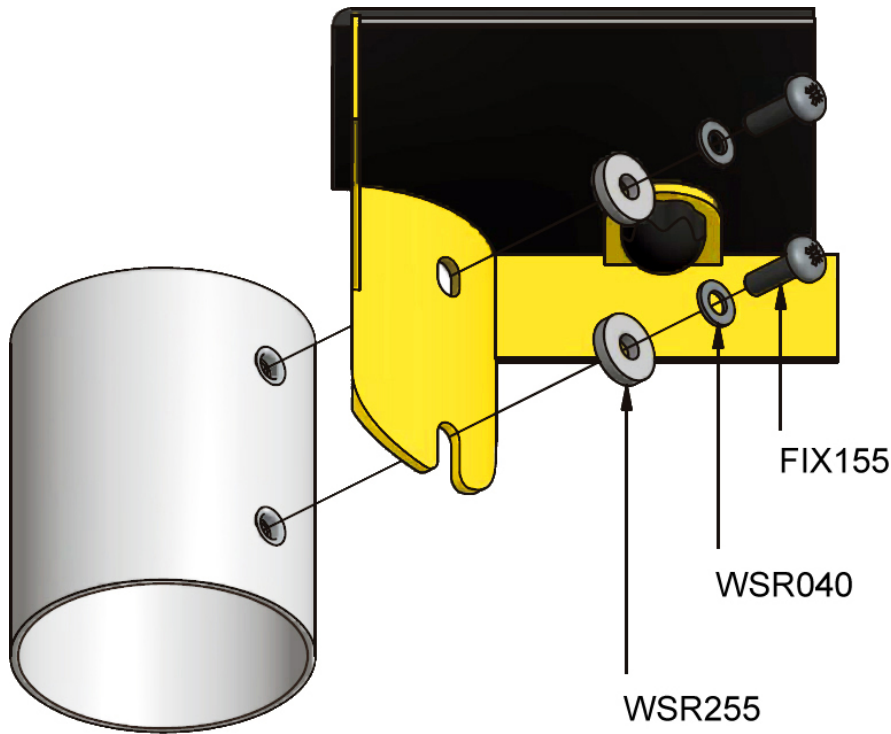

SANDWICH THE NYLON  
WASHER (WSR255)  
BETWEEN THE M10 PLAIN  
WASHER (WSR040) AND  
DECK MOUNTING PLATE

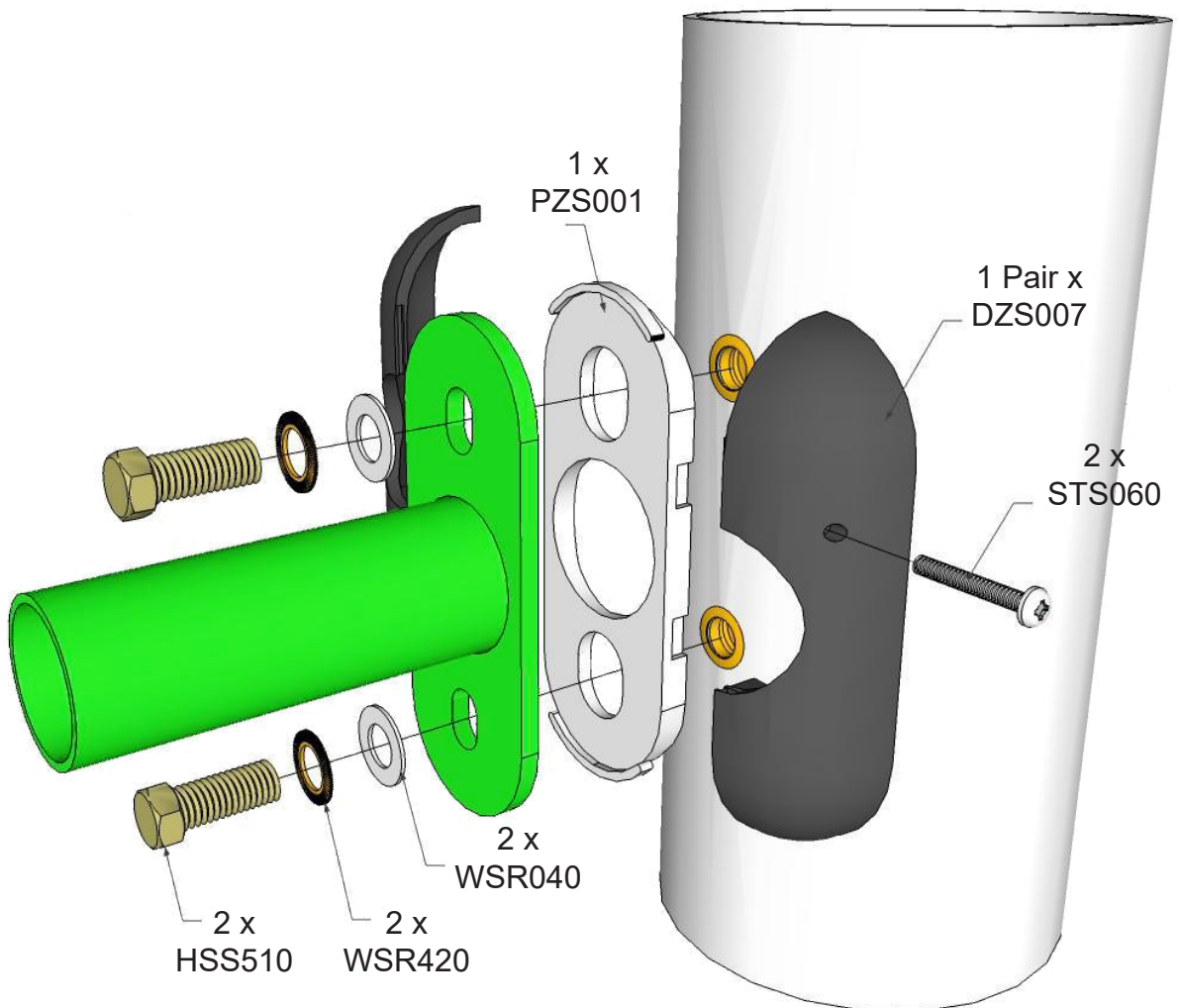

# PZU1000

Playzone Unit  
Assembly

design  
make  
play  
**SutcliffePlay**

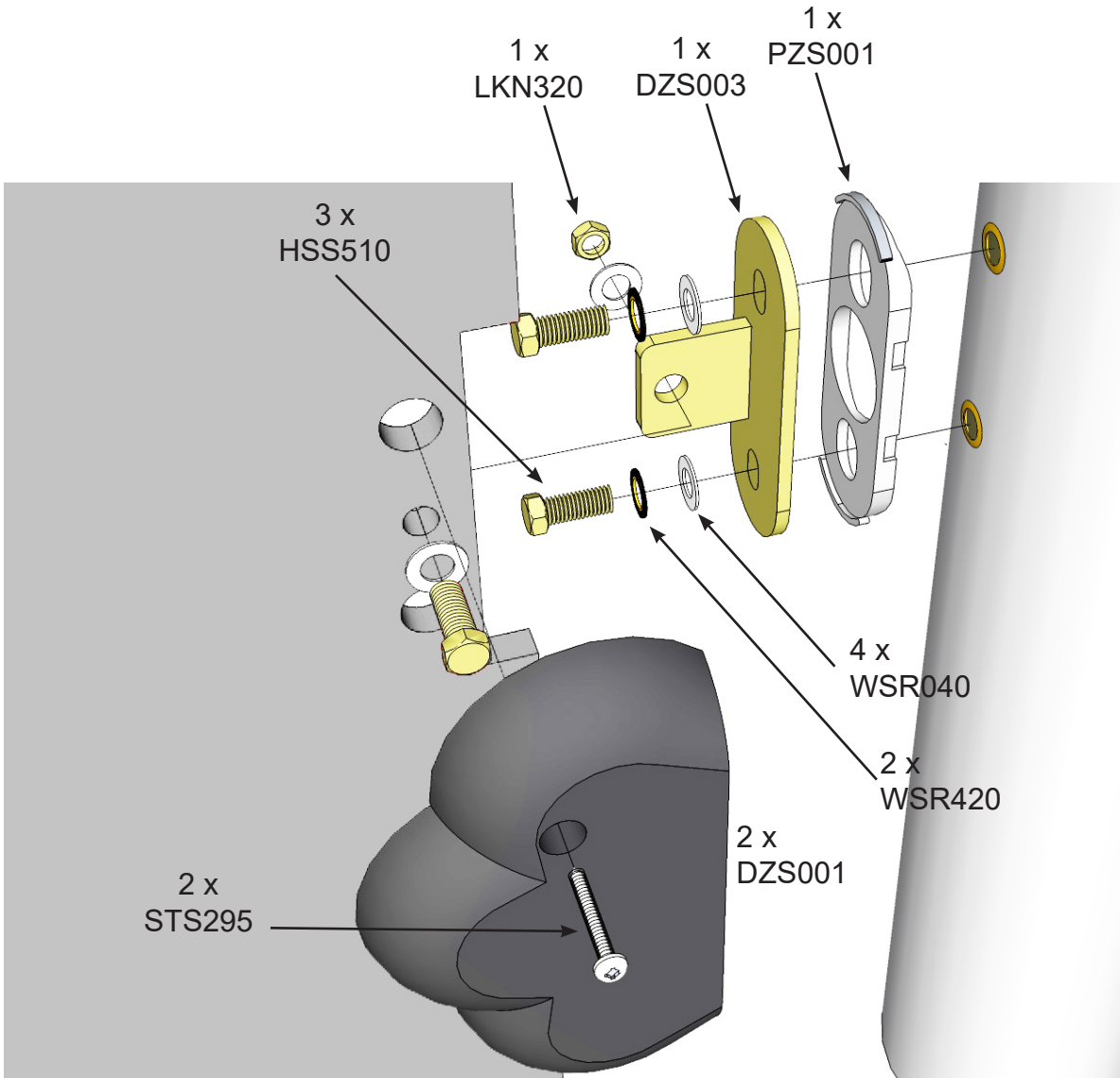

# PZU1000

Playzone Unit  
Assembly

design  
make  
play  
**SutcliffePlay**

When fitting seats, ensure that they are all level.  
Loosen fixings if required.

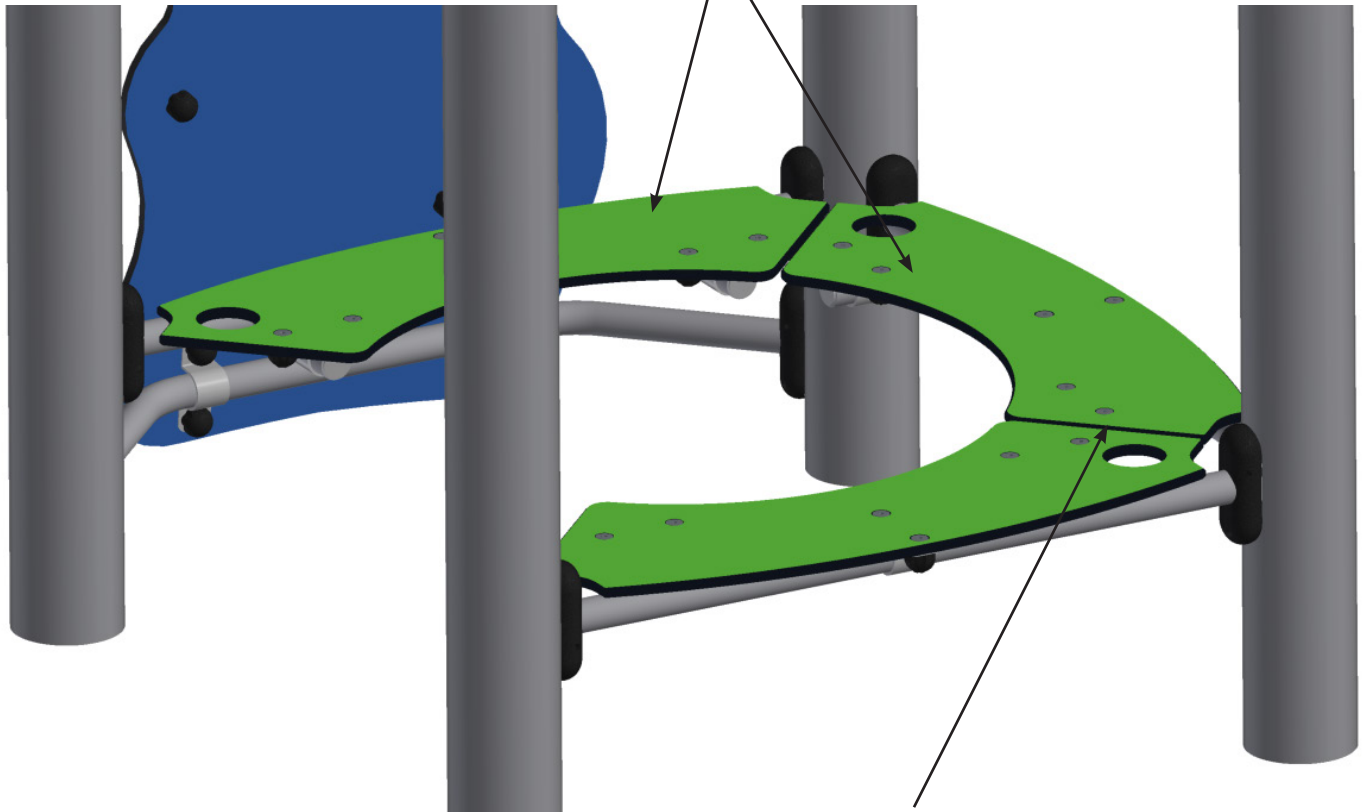

Gap between  
panels to be no  
more than 7mm

All bolts are fixed with  
DZS009 step washers,  
LKN320 lock nuts and  
DZS005 nut caps.

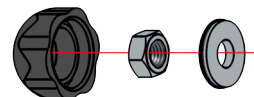

# PZU1000

Playzone Unit  
Assembly

design  
make  
play  
**SutcliffePlay**

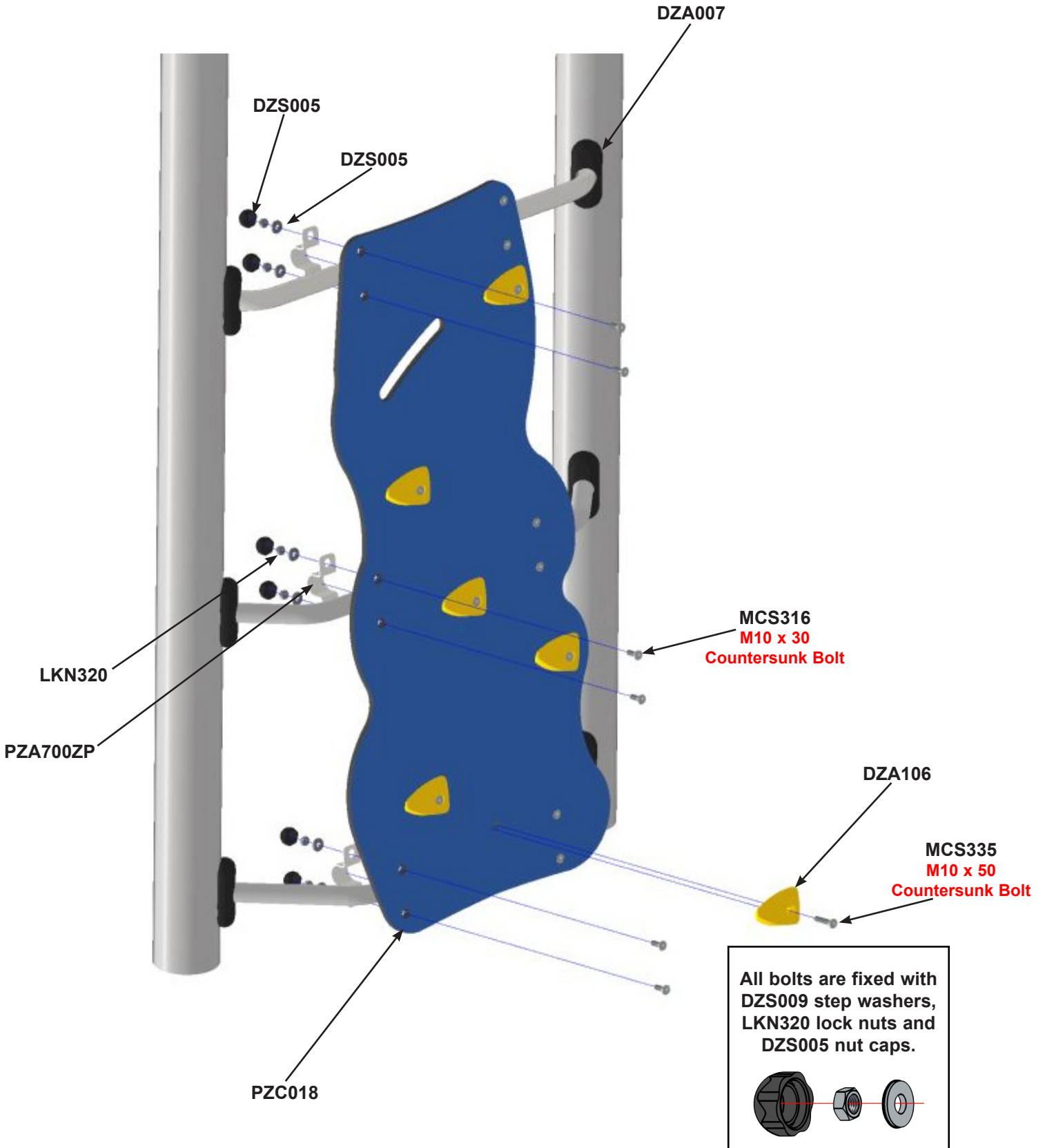

# PZU1000

Playzone Unit  
Assembly

design  
make  
play  
**SutcliffePlay**

PZ1542G

1.8m Green Tube Slide

OFFER THE SLIDE TOP INTO THE PANEL BED, AND SANDWICH INTO POSITION BY BOLTING THE CURVED PANELS OVER IT. TWIST THE SLIDE INTO A POSITION THAT ALLOWS THE RUN-OUT TO SLOPE DOWNWARDS. USING THE 2 GUIDE HOLES IN THE PANEL, DRILL THROUGH THE SLIDE AND BOLT THROUGH BOTH SIDES.

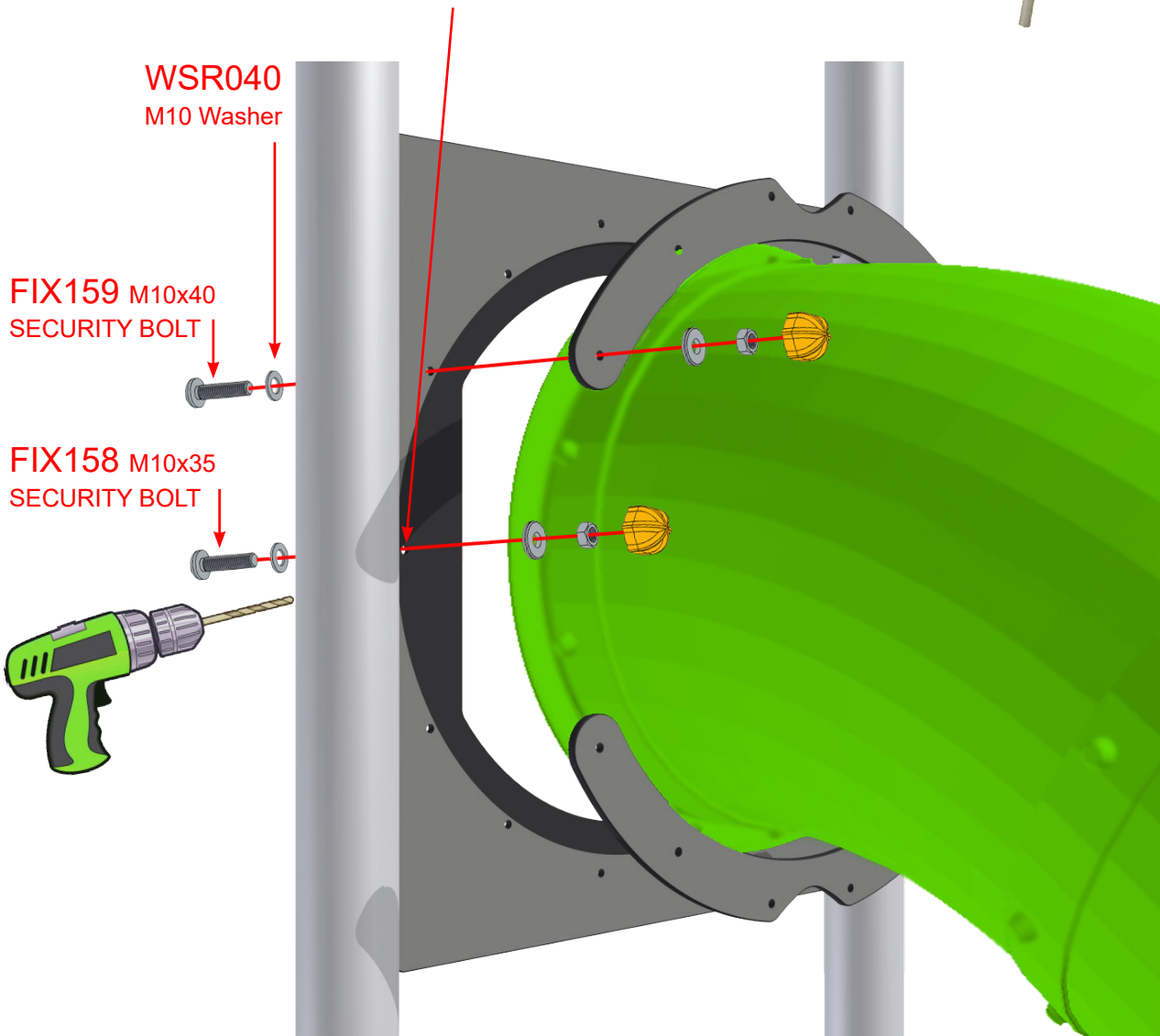

# PZU1000

## Playzone Unit Assembly

For the penultimate section of the slide, attach the bracket to the supports. Screw with M8x20mm locking screws. Adjust the holder so that the pipe in which the support is inserted, is in a horizontal position.

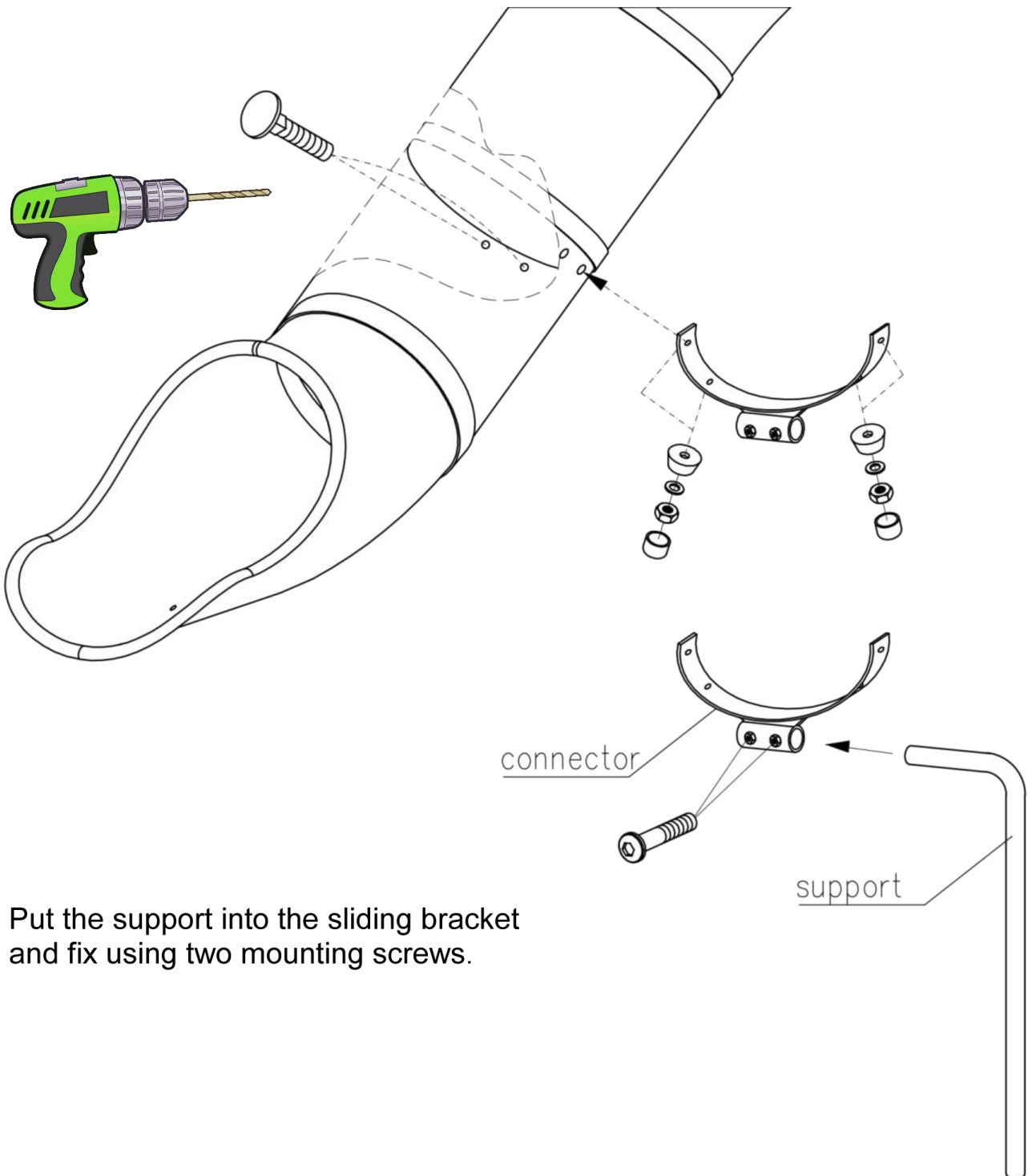

Put the support into the sliding bracket  
and fix using two mounting screws.

# PZU1000

## Playzone Unit Assembly

design  
make  
play  
**SutcliffePlay**

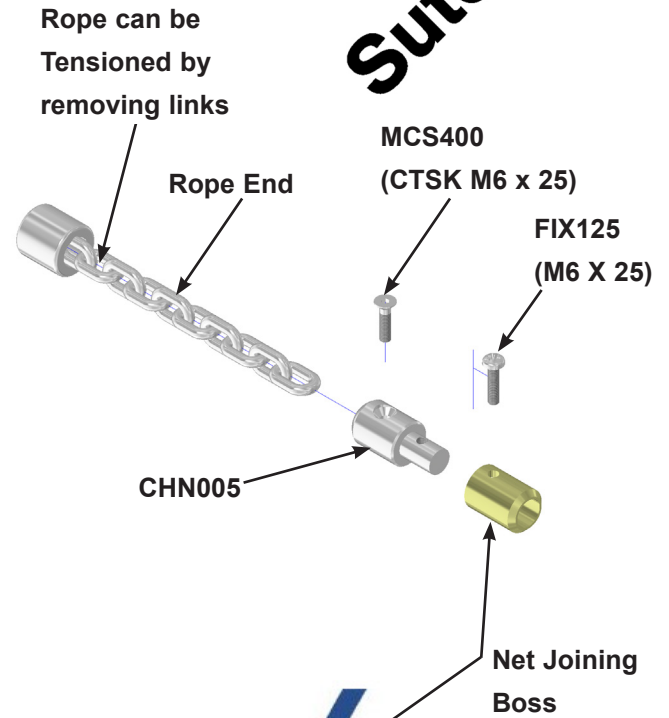
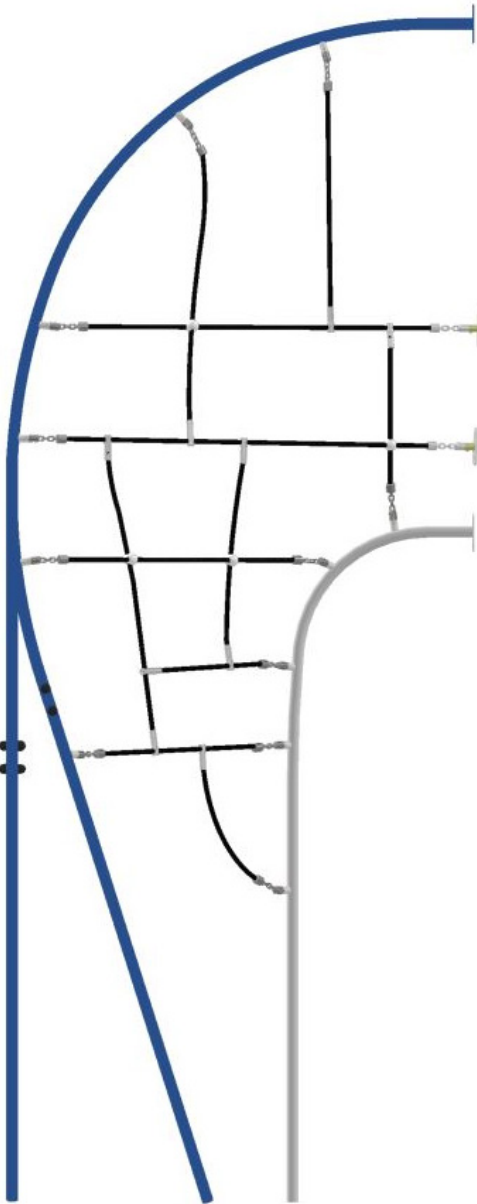

PZC007  
Top Rail

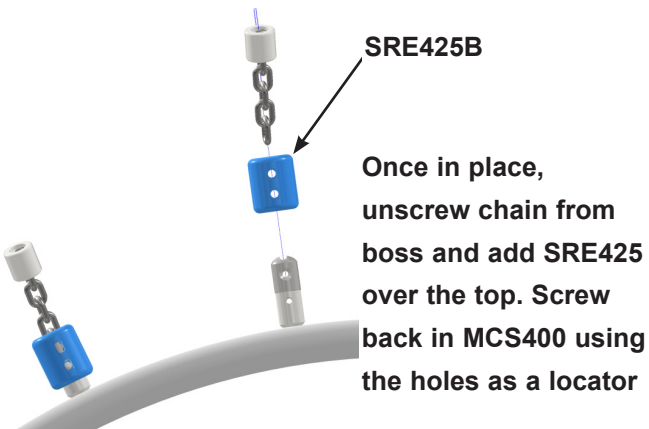
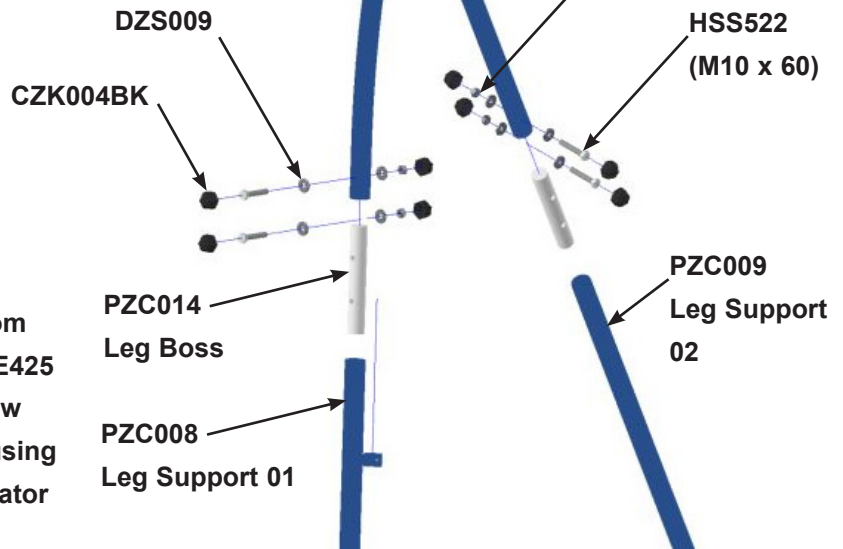

# PZU1000

## Playzone Unit Assembly

Apply the anchor to the outlet of the slide at a distance of 70cm from the edge, as in the drawing. Drill two holes with a 8mm bit. Fasten the steel anchor using M8 locking screws. The screw should be on the inner side of the slide, the cap with the plastic cap on the side of the anchor.

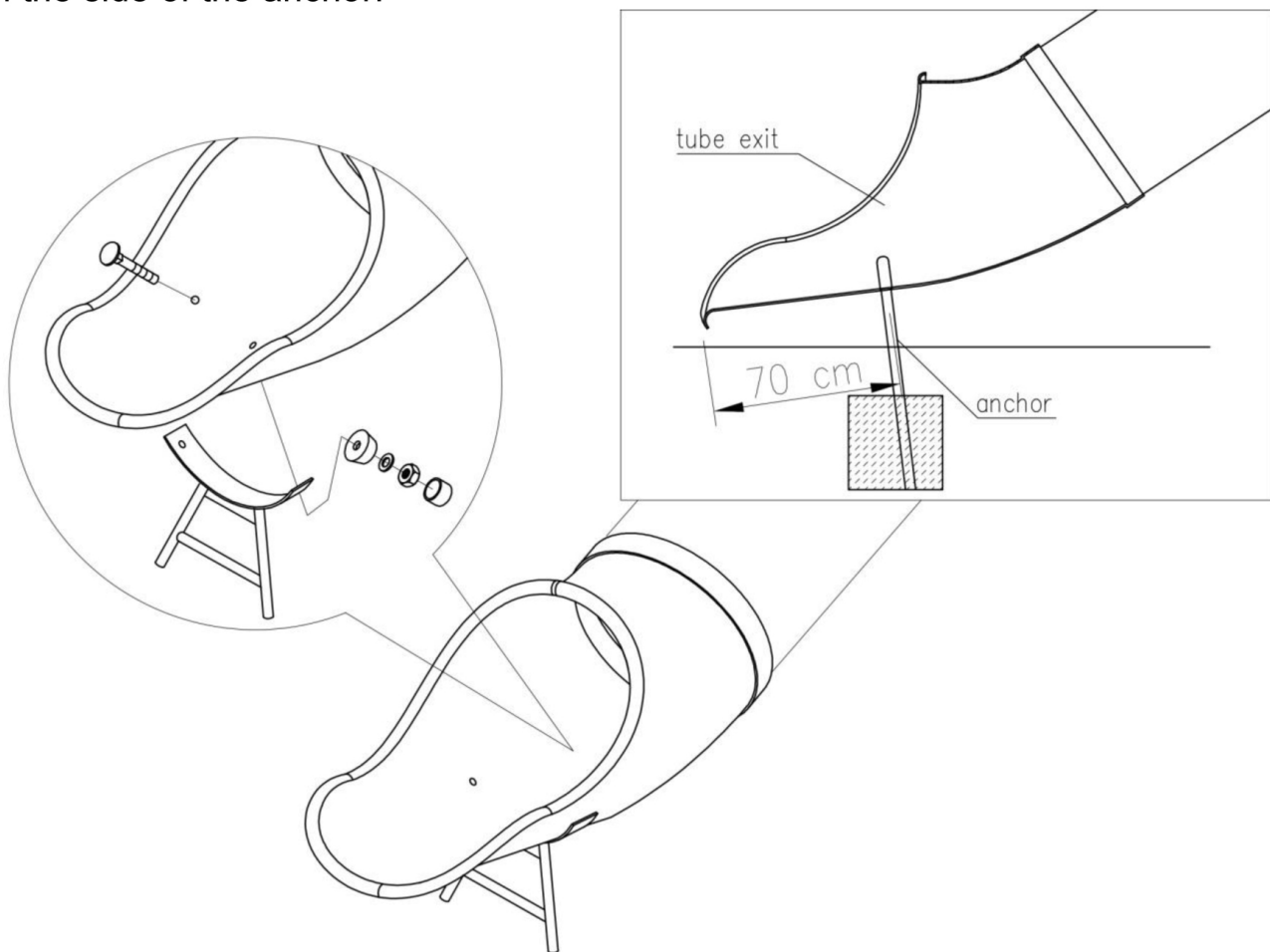

Assembly of the slide to the tower with round poles  $\text{Ø}114\text{mm}$ . Fix the panel from the top using the clamps and fasteners to the poles, and screw the panel to the platform at the bottom.

# PZU1000

## Playzone Unit Maintenance Instructions



### NOTE

The warranty is invalidated if these instructions are not followed.  
All wood needs annual inspection and retreatment where required.

### Recommended Regular Inspection and Maintenance

	Interval Days				
	7	14	28	56	365
Check stability of structure, tighten connections if required.	<input type="checkbox"/>	<input type="checkbox"/>	<input type="checkbox"/>	<input checked="" type="checkbox"/>	<input type="checkbox"/>
Check all uprights at ground level for corrosion and/or rot. Replace any defective parts.	<input type="checkbox"/>	<input type="checkbox"/>	<input type="checkbox"/>	<input type="checkbox"/>	<input checked="" type="checkbox"/>
Check all painted elements for damage, rub down and repaint or replace as required.	<input type="checkbox"/>	<input type="checkbox"/>	<input type="checkbox"/>	<input checked="" type="checkbox"/>	<input type="checkbox"/>
Check chain/ropework assemblies for wear and damage, replace if required.	<input type="checkbox"/>	<input checked="" type="checkbox"/>	<input type="checkbox"/>	<input type="checkbox"/>	<input type="checkbox"/>
Check rotating and pivot points for wear and smooth running lubricate or replace if required.	<input type="checkbox"/>	<input type="checkbox"/>	<input checked="" type="checkbox"/>	<input type="checkbox"/>	<input type="checkbox"/>
Check rubber parts for wear and/or damage, replace if required.	<input type="checkbox"/>	<input type="checkbox"/>	<input checked="" type="checkbox"/>	<input type="checkbox"/>	<input type="checkbox"/>
Check tension cables, adjust if required.	<input type="checkbox"/>	<input type="checkbox"/>	<input checked="" type="checkbox"/>	<input type="checkbox"/>	<input type="checkbox"/>
Check wear of cables, replace if required.	<input type="checkbox"/>	<input type="checkbox"/>	<input checked="" type="checkbox"/>	<input type="checkbox"/>	<input type="checkbox"/>
Check slide chutes for smoothness and any foreign elements, remove any found.	<input type="checkbox"/>	<input type="checkbox"/>	<input checked="" type="checkbox"/>	<input type="checkbox"/>	<input type="checkbox"/>
Check rubber safety surfaces for damage and poor performance, repair or replace if required.	<input type="checkbox"/>	<input type="checkbox"/>	<input type="checkbox"/>	<input checked="" type="checkbox"/>	<input type="checkbox"/>
Check loose fill safety surfaces, remove any foreign elements, rake level and top up if required.	<input type="checkbox"/>	<input type="checkbox"/>	<input checked="" type="checkbox"/>	<input type="checkbox"/>	<input type="checkbox"/>

### Disposal Instructions

All components should be broken down into categories of:-

- 1 **Mild Steel** - all Swing Frames, Playzone, Toddlerzone, Teenzone activities, Deck Frames and Springie Frames.
- 2 **Stainless Steel** - all Slides, Mirror Panels.
- 3 **Aluminium** - all Playzone and Toddlerzone Posts.
- 4 **Galvanised Steel** - all Chains and Teenzone Posts.
- 5 **Moulded Rubber Products without steel inserts** - all Toddlerzone Caps and edge details.
- 6 **Timber** - all natural timber, plywood, and MDF panels.

Wherever possible these materials should be taken to specialist recycling organisations and recycled.

In some cases where composite materials are used, then disposal at land fill sites is the only alternative such as:

- 7 **Moulded Rubber Products encasing steel inserts** - all Swing Seats, Deck Tops, Duo/Dizzy Disc Tops.
- 8 **High Pressure Laminate** - all Toddlerzone, Playzone and Teenzone Panels.
- 9 **Steel Core Polypropylene Rope** - all Scramble Nets, Space Nets, Playzone/Toddlerzone Ropes.