

# CLD Rampart 30

Multi-threat Security Fence to LPS 1175 A1, B3, C3 & D10 (SR1, SR2, SR3 & SR4) and HVM to PAS 68:2010



Find out more  
Scan for more information

## Description

CLD Securus Rampart takes multi-threat protection to a new level for data centres and high risk sites, offering a high security fence system combined with a shallow foundation hostile vehicle mitigation. Securus Rampart 30 is tested to PAS 68:2010 – can stop a 7.5 tonne vehicle moving at 30 miles per hour (48 kilometres per hour) Each version can be used with either of CLD's LPS 1175 security rated Securus fence panels, meaning the system also offers protection against manual attacks or climbing.

## Features

Ideal for: Data Centres,  
Police and military,  
government sites, nuclear

HVM 10m post centres

Short and long runs - no special  
posts or fitting needed for  
corners or direction changes

Only 400mm foundation and  
small footprint size.

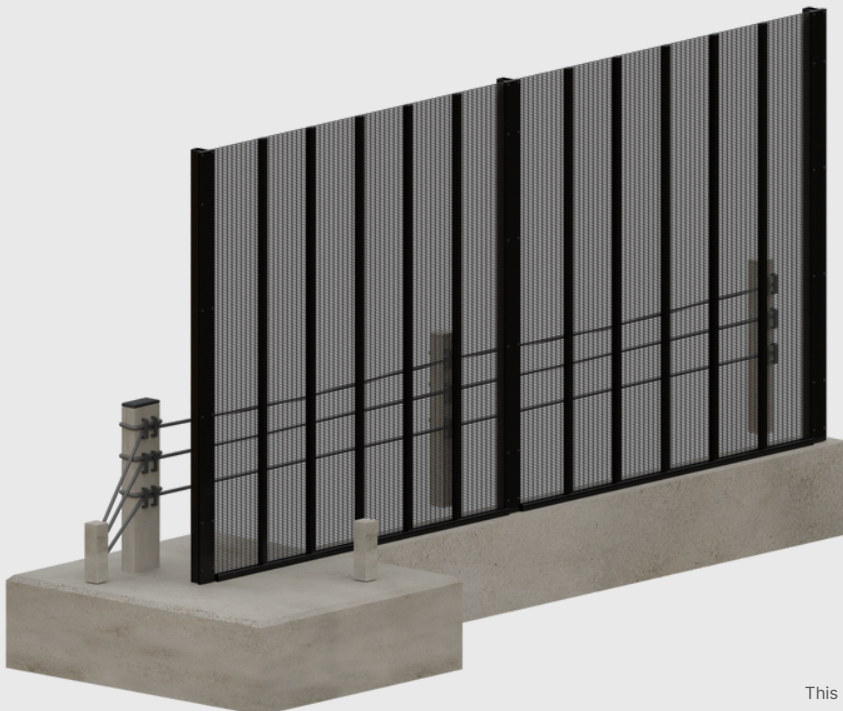

Exploded view of post and fixing details for the CLD Rampart 30  
This product has additional features not demonstrated for security reasons



# CLD Rampart 30

Multi-threat Security Fence to LPS 1175 A1, B3, C3 & D10 (SR1, SR2, SR3 & SR4) and HVM to PAS 68:2010



## Product Technical Information

Standard	LPS (1175 SR1, SR2, SR3 or SR4) Issue 8 PAS68:2010 V/7500(N2)/48/90:3.4/6.4 Secured By Design
Fence Type	Shallow foundation hostile vehicle mitigation system for use with CLD Securus S1, S2, S3 or S4 panels. See separate specification sheets for mesh fence panels
Post Height	HVM: 1080mm from finished floor level
Main post width	200mm
Post depth	400mm with 50mm concrete blinding
Tolerance	+/- 10mm
Concrete specification	C40/50 with 10mm grit
Sling Length	Rope Slings: 7500mm standard, bespoke available Anchor Slings: 1000mm standard
Rope quantity	3
Rope diameter	22mm galvanised or 22.15mm coated
Rope finish	Galvanised or Black high-density polyethylene (HDPE) coating
Fence finish	Polyester powder-coated to 60-80 microns or 160-200 microns with marine grade and metallics. Any RAL colour available
End foundations	2000 long x 2000mm wide x 400mm deep
Intermediate foundations	1000mm long x 1200mm wide x 400mm deep
Line Support foundations	300 x 300 x 400mm
Warranty	Minimum of 15 years against manufacturing defects

## System Details



## Disclaimer

Fencing should be installed in accordance with BS 1722-14. Every care has been taken to ensure that all information provided on this data sheet is accurate. CLD Fencing Systems Ltd reserves the right to change product specification at any time. Please ensure that you have the latest information which can be found on our website or by contacting our team.

Document Reference - CLD\_Rampart\_30\_DS\_20230223