

# Installation Instructions



1. Attach the steel legs to the base of the instrument with the M8 Nyloc Nuts and 2 part security caps. **(1.1)** (See Assembly Guide)

2. Attach Ground Fixing posts to legs **(1.2)** (See Ground Fix Post Installation Sheet)

3. Excavate 1 hole for the Steel legs **250mm diameter** by **350-500mm deep** depending on Key stage, in desired location upon decision from customer.

4. Locate (lower) leg into holes making sure they are vertical and level prior to concreting in place.

5. Once happy with location of the Instrument, **fill** holes using rapid hardening **concrete**. Be sure to compact concrete around legs and leave to dry according to manufactures guidelines.

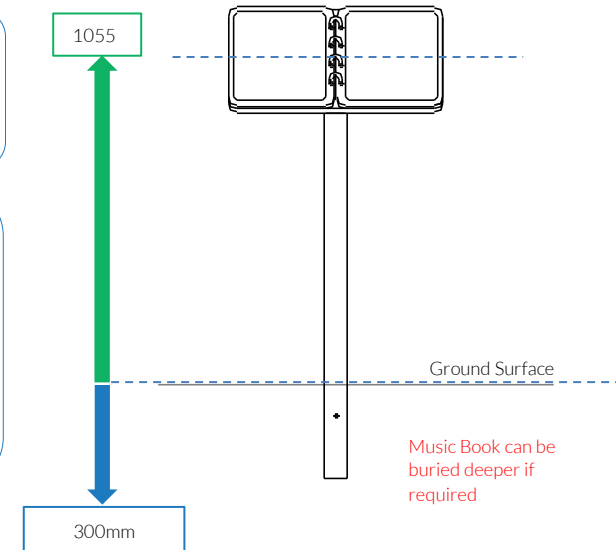
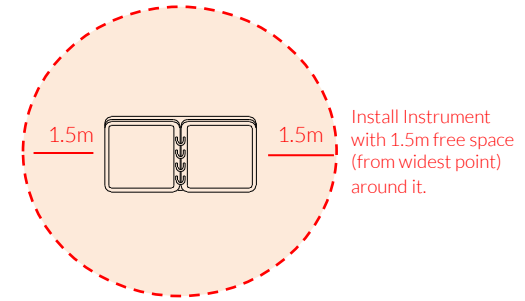

Weight of heaviest part **10kg** (Music Book)

## Ground Fixed

Music Book  
Page 1 of 3



## Instrument Components:

x4  
M8 Nyloc Nut

x4  
2 Part Cover Cap M8

Metric  
Conversion:  
250mm/ 10"  
300mm/ 12"  
450mm/ 18"  
700mm/ 28"  
850mm/ 33"  
1.5m/ 59"

Ground Fix  
Components:

x2  
M10x200  
Threaded Bar

x4  
M10 Nut



Spares available from  
[percussionplay.com](http://percussionplay.com) or from your  
local distributor

19.5 Kg

## Ground Fixed

Music Book  
Page 2 of 3



### Instrument Components:

 x4  
M8 Nyloc Nut

 x4  
2 Part Cover Cap M8

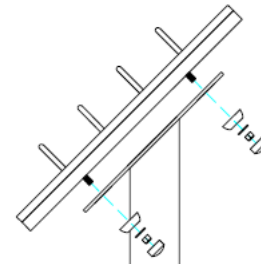
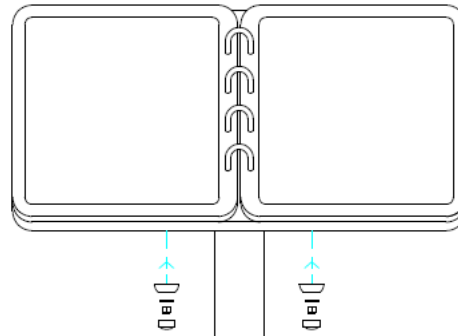

### COMPONENTS LIST:



2 Part Cover Cap M8 X4



M8 FormC Washer X4



M8 Nyloc nut X4



M10 Nut X4



M10x200 Threaded Bar X2



PPMUSI FRONT

PPMUSI SIDE



x2  
M10x200  
Threaded Bar

 x4  
M10 Nut



# Ground Fix Post Installation

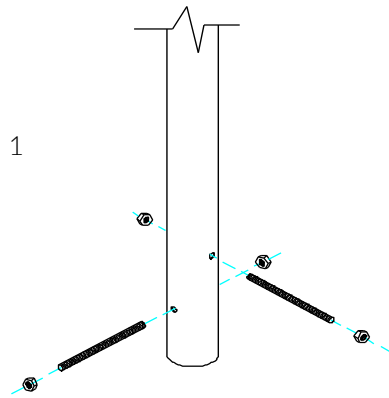

1

Insert M10x 200 Threaded bar into pre drilled holes in Ground Fixing Post

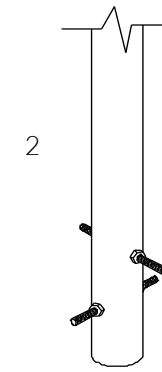

2

Fix M10x 200 Threaded bar in place using M10 Nuts

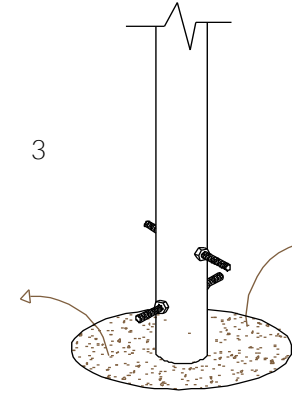

3

Excavate a hole with a 250mm diameter tapering down to 350mm diameter and 350mm depth

Foundations should not present a hazard. These foundations are recommended as a guide, for more information on foundation details for various surface see Part 1 of BS EN 1176.

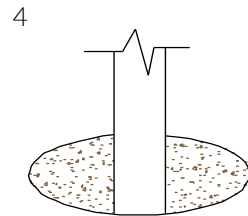

4

Compact base of hole with 50mm of aggregate. Lower ground Fix post attached of instrument straight and level before filling with concrete)

300mm min depth

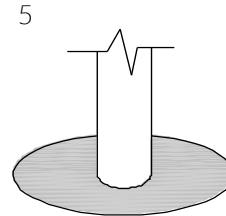

5

Fill hole with fast drying concrete to manufacturers specifications.

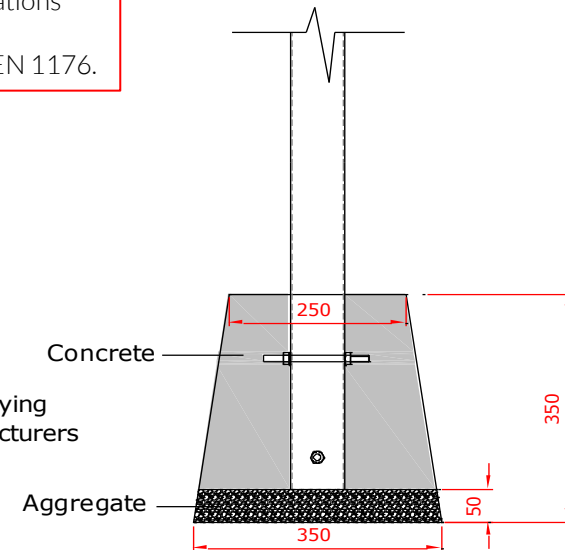

## Ground Fixed

Music Book  
Page 3 of 3



## Components:



### Metric Conversion:

50mm/ 2"  
250mm/ 10"  
300mm/ 12"  
350mm/ 14"  
400mm/ 16"  
450mm/ 18"

