

<h1>Rotaplay</h1>	
<h2>Dizzy Roundabout</h2>	
PROD. CODE	6020-072 (872)
SIZE	Ø1500 x 500mm High
AGE RANGE	6-14 Years
F/ FALL HEIGHT	1000mm
HEAVIEST PART	47.5 Kg
TOTAL WEIGHT	95 Kg
	

SPECIFICATION

Solid steel components made from steel to BS 970 Part 1 (1983)
 Tubing made from medium Nominal Bore Tube to BS 1387
 Standard fasteners are plated and made to one of the following specifications:-
 BS 3692 (1697), BS 4190 (1967)
 Non-standard fasteners are corrosion resistant and designed to deter vandals
 Welds are from copper free wire to BS EN 440 (1995)
 Metal parts coated with low lead polyester paint to BS EN 71 part 3 (1995)

INSTALLATION INSTRUCTIONS

1. Read instructions thoroughly before commencing installation of unit.
2. Excavate foundations as shown on the foundation plan.
3. Position the below ground fixing in the prepared hole, ensuring that it is vertical and at the correct height.
4. Backfill with 0.162 cubic m concrete (4 parts gravel, 2 parts sand & 1 part cement).
5. Allow concrete to set for a period of 48 hours.
6. Once foundations have set, position the bearing unit and attach to below ground fixing. Make sure bearing unit cover is in position before fixing down to ground fixing. Ensure that all fasteners are fully tightened.

Note

Note ENSURE ALL INSTALLATION AIDS ARE REMOVED BEFORE FIRST USE!

Foundation Detail

(Care must be taken in abnormal conditions)

Wetpour

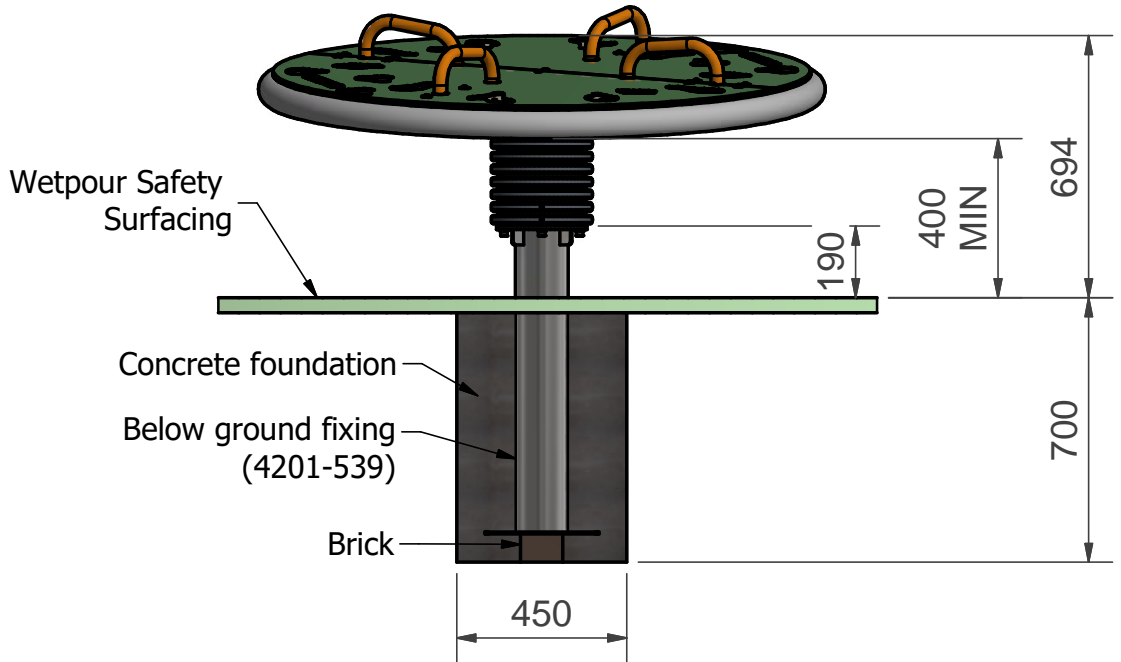

Bark

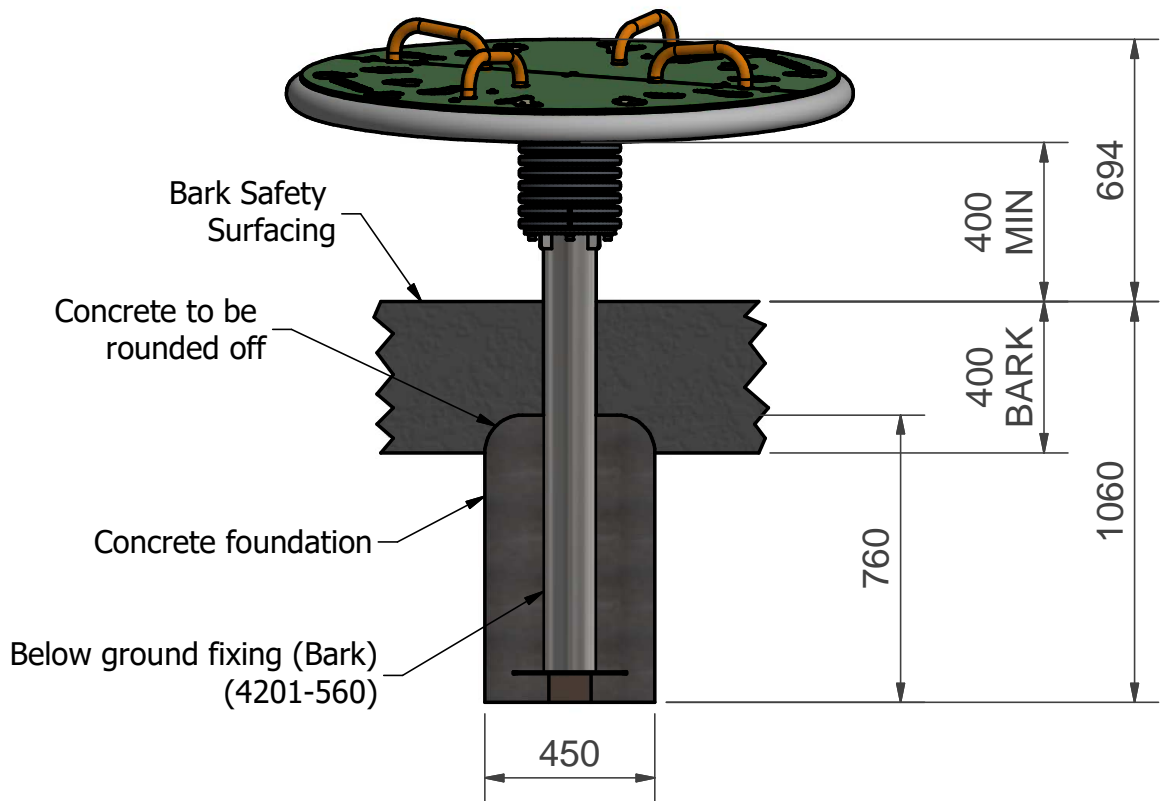

Free Space

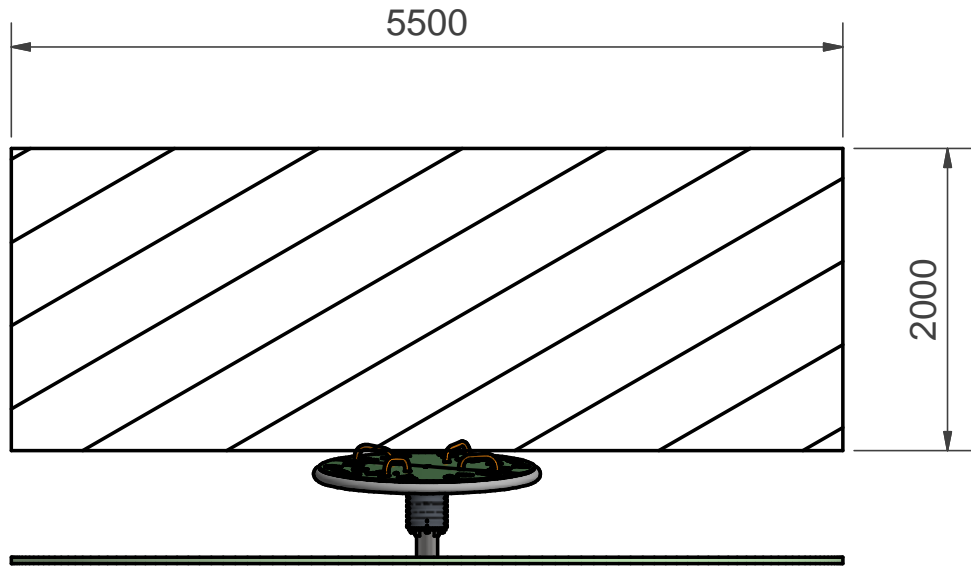

Safety Surfacing
Wetpour

Max FFH = 1000mm

24.0 Sq. metres of wetpour area
17.5 Linear metres wetpour edging

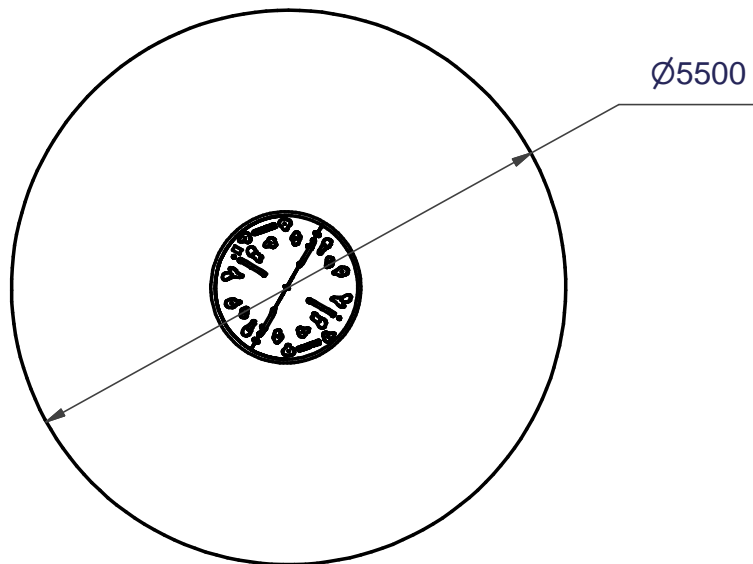

Safety Surfacing

Grass Mats

24 No. 1m x 1.5m Wicksteed grass mats

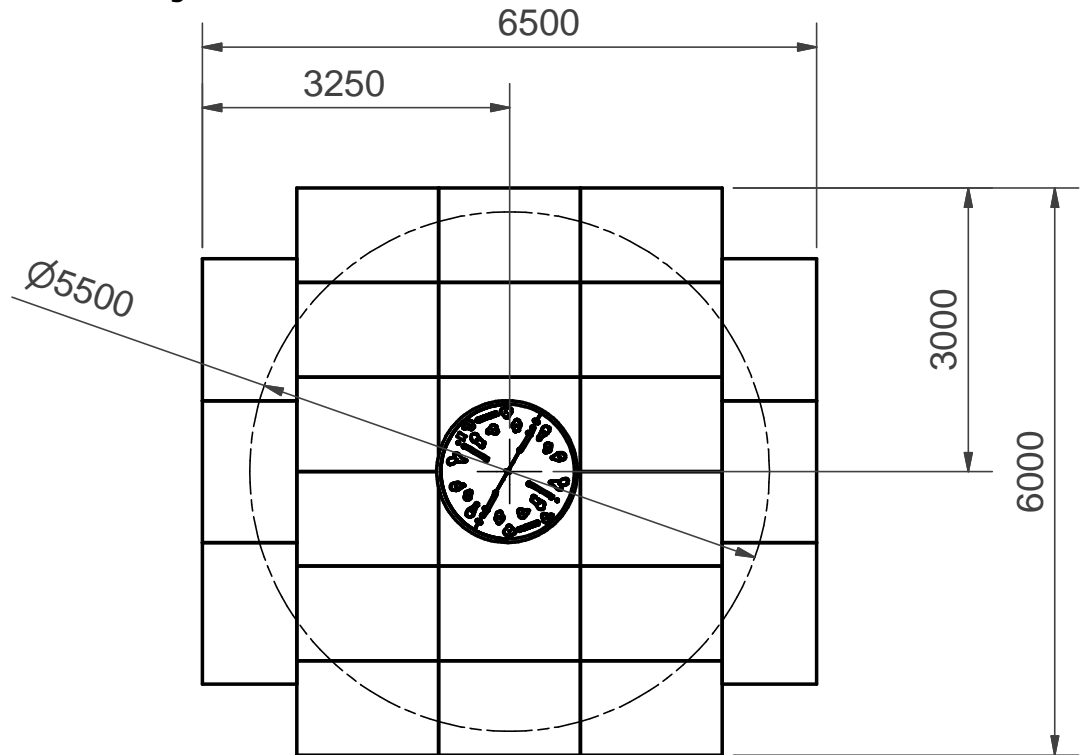

Bark

18.5 Linear metres edging

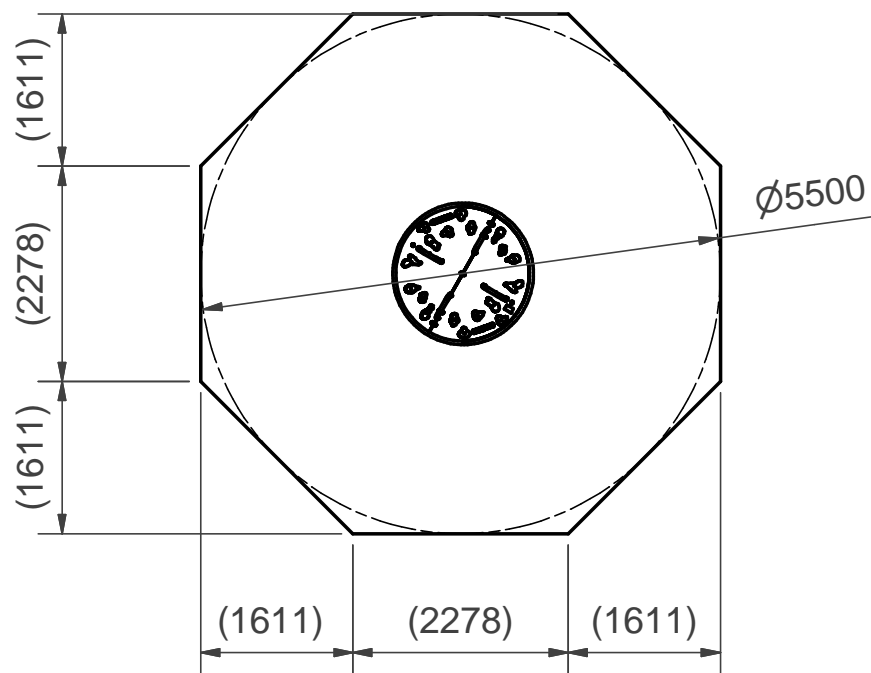

Fixing Details For Maintenance

Deck Frame To Bearing Unit

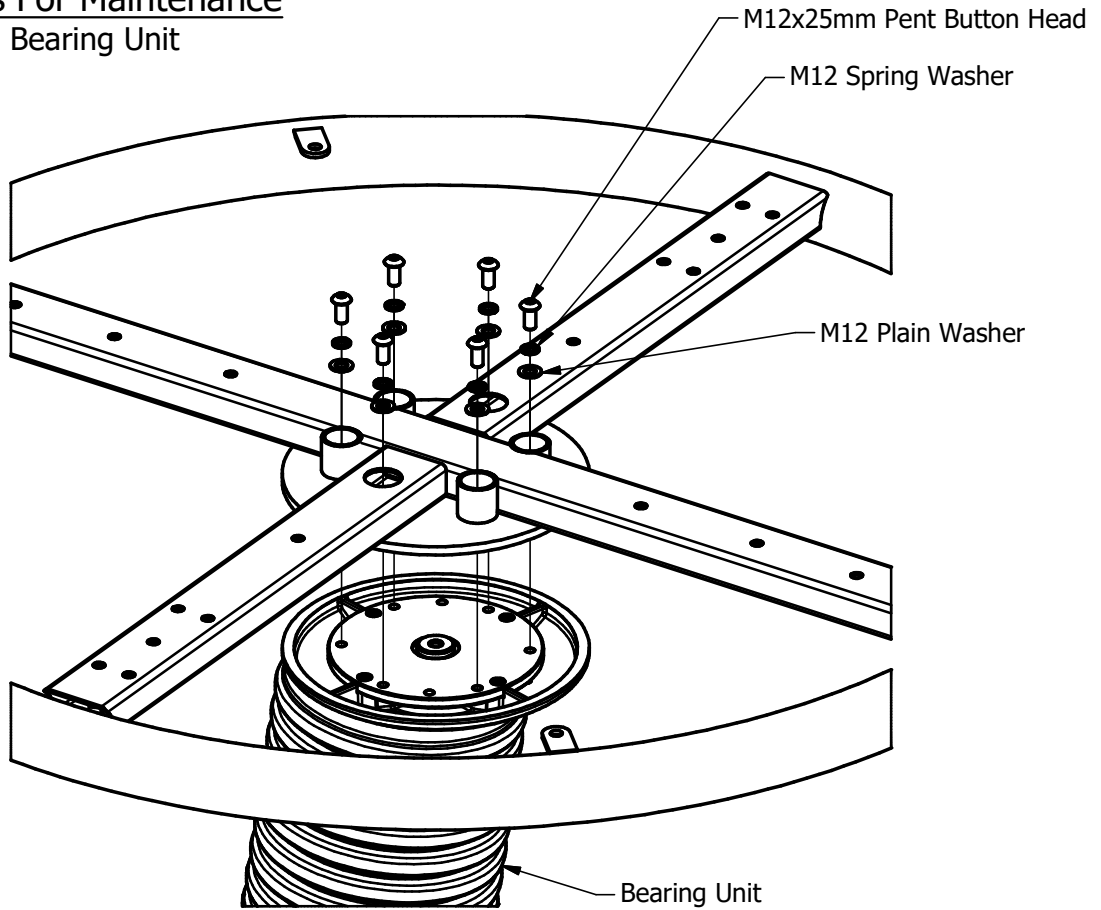

Fixing Details For Maintenance

Bearing Unit To Below Ground Fixing

Below ground fixing to be concreted in to ground 48 hours prior to attaching bearing assembly. Shown here for clarity purposes only.

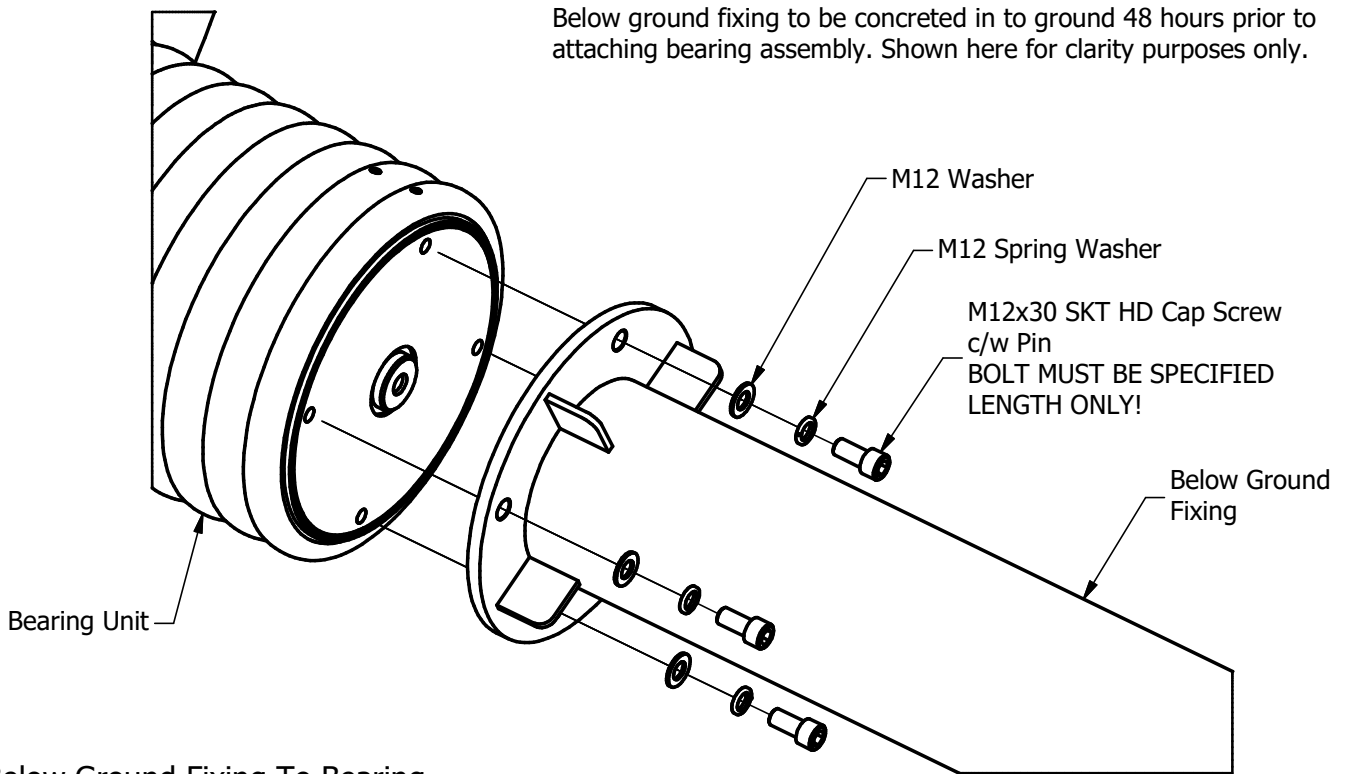

Below Ground Fixing To Bearing

Fixing Details For Maintenance
Panel and Handle to Deck Frame

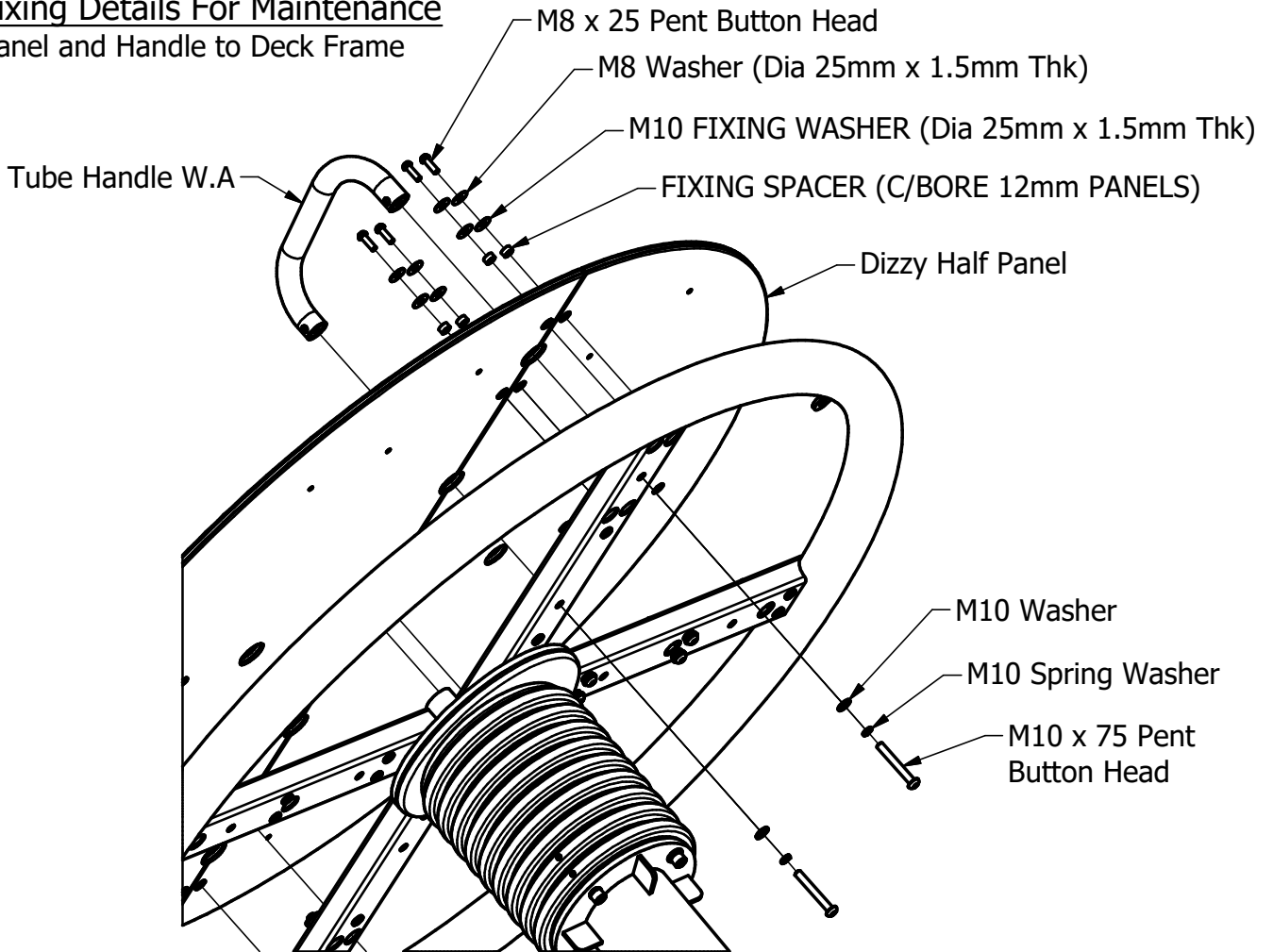

Fixing Details For Maintenance
Underside Covers To Framework

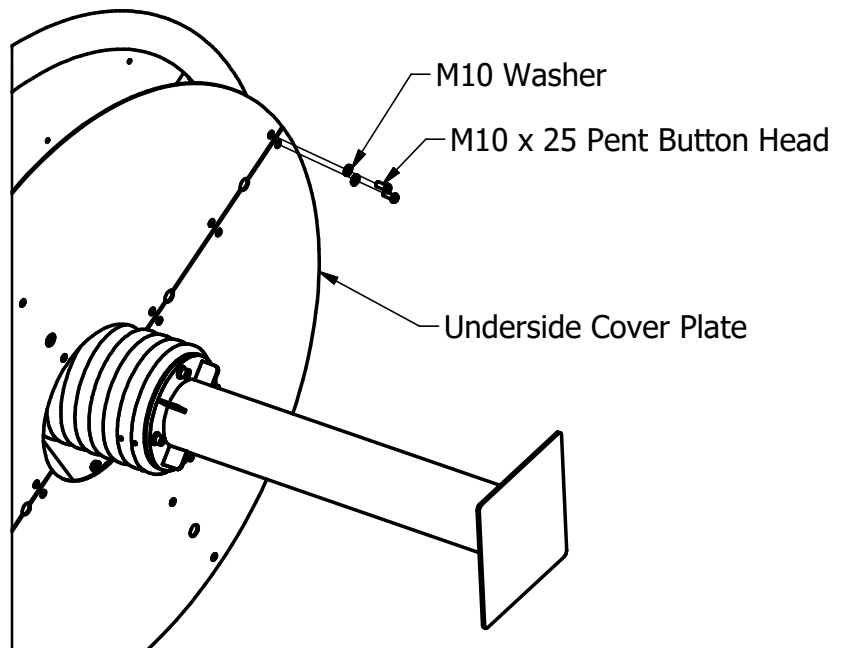

Fixing Details For Maintenance
Bearing Assembly

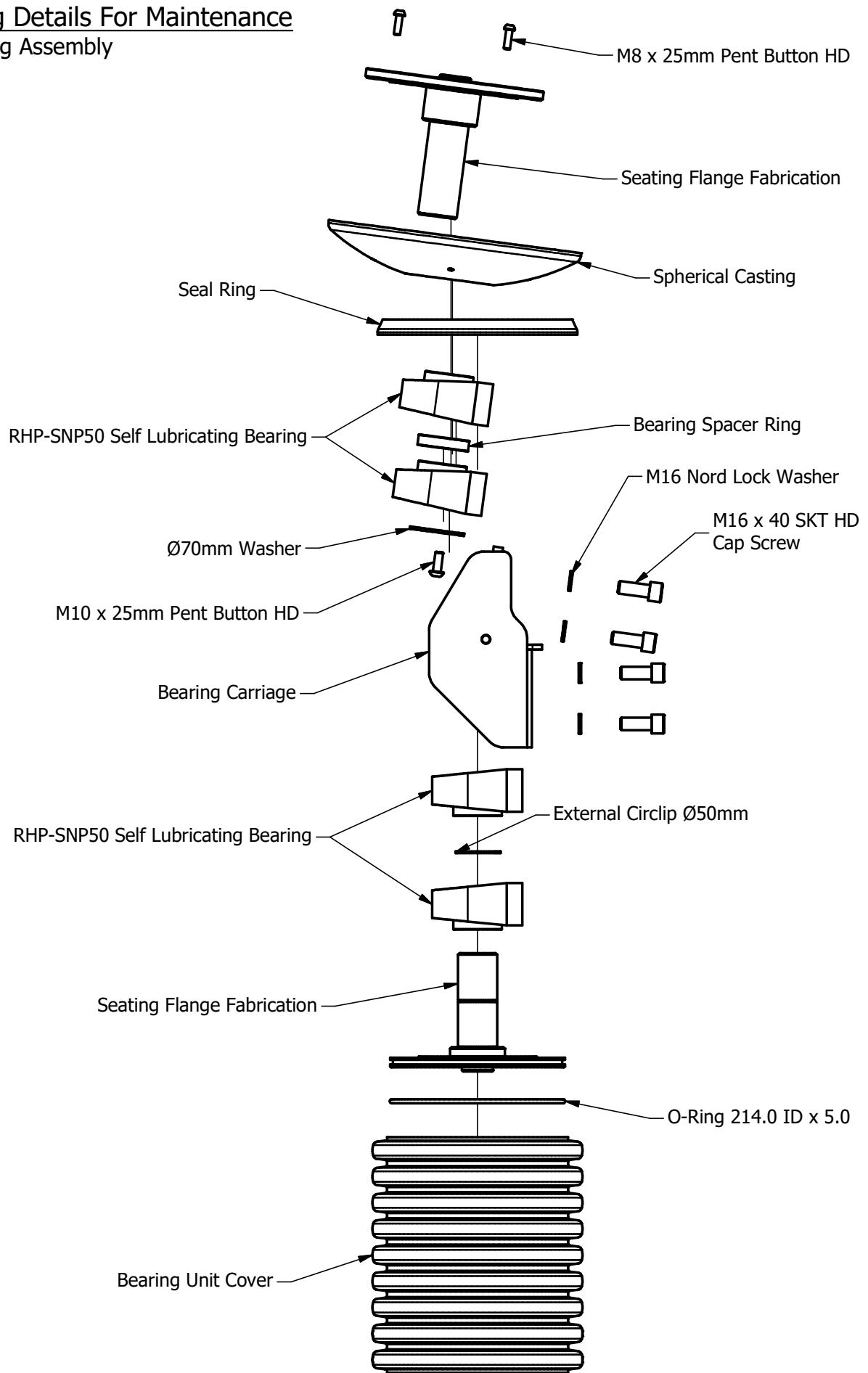

ITEM	QTY	PART NUMBER	DESCRIPTION
1	1	5094-056	Support Frame & Panel Assy
3	1	4201-539	Below Ground Fixing Assembly
4	4	2215-509	M12 Plain Washer
5	4	2212-002	M12 Spring Washer
6	4	2171-226	M12 x 30 Skt Hd Cap Screw c/w Pin

For bark safety surfacing item 3 is: 4201-560

COMPILED DB	REV	9	10	11	12					
	ECN	minor	minor	1818	1846					
DATE: 09/12/10	SIG.	AB	MC	MC	MC					
	DATE:	07/12/17	02/03/20	19/10/21	12/06/23					

